

**GENERAL NOTES**

1. ALL WORKMANSHIP WILL BE TO THE STANDARDS OF LANDSCAPE ONTARIO.
2. ALL PLANT MATERIAL TO BE NO. 1 GRADE NURSERY GROWN IN ACCORDANCE WITH THE CANADIAN STANDARDS FOR NURSERY STOCK, 9TH EDITION, 2017, BY THE CANADIAN NURSERY TRADES ASSOCIATION.
3. BACKFILL WILL CONSIST OF SOIL NATIVE TO THE SITE OR GENERAL SOIL TYPE/CLASS NATIVE TO THE SITE.
4. CONTRACTOR SHALL MAINTAIN ALL LANDSCAPE AREAS UNTIL OWNER'S ACCEPTANCE OF PROJECT.
5. CONTRACTOR TO LOCATE ALL UNDERGROUND UTILITIES.
6. PLANTING MAY BE ADJUSTED TO SUIT LOCATIONS OF SITE UTILITY STRUCTURES/SERVICES.
7. ALL MATERIALS MUST BE APPROVED BY LANDSCAPE ARCHITECT PRIOR TO INSTALLATION.
8. SPREAD MULCH TO A MINIMUM OF 100mm COMPACTED DEPTH ON ALL TREE FITS AND PLANTING BEDS.
9. CHECK AND VERIFY ALL DIMENSIONS AND QUANTITIES PRIOR TO COMMENCEMENT OF WORK. ANY DISCREPANCIES ARE TO BE REPORTED IN WRITING TO THE LANDSCAPE ARCHITECT. QUANTITIES NOTED WITHIN THE PLAN SUPERCEDE THOSE IN THE PLANT LIST. ANY SUBSTITUTIONS SHALL BE APPROVED BY THE LANDSCAPE ARCHITECT.
10. SOD AS MARKED WITH NURSERY SOD ON A MINIMUM OF 100mm OF CLEAN TOPSOIL, FINE GRADE AND SOD ALL SOULAVARD AREAS TO MUNICIPAL SPECIFICATIONS AND REPAIR DAMAGE TO ADJACENT PROPERTIES, AS REQUIRED.
11. FINAL INSPECTION AND ACCEPTANCE OF PLANTING WORK SHALL COINCIDE WITH THE FINAL INSPECTION AND ACCEPTANCE OF ALL WORK INCLUDED IN THE CONTRACT.
12. ALL SEEDED SLOPES 3:1 AND GREATER TO RECEIVE EROSION CONTROL MATTING. PIN SOD ON ALL SLOPES OF 3:1 OR GREATER.
13. SUBMIT A WRITTEN GUARANTEE TO THE EFFECT THAT ALL PLANTS ACCEPTED DURING THE PERIOD OF JANUARY 1st TO JULY 15th SHALL BE GUARANTEED UNTIL JULY 15th THE FOLLOWING YEAR. PLANTS ACCEPTED DURING THE PERIOD OF JULY 15th TO DECEMBER 31st SHALL BE GUARANTEED FOR ONE YEAR FROM THE DATE OF ACCEPTANCE. THE GUARANTEE PERIODS LISTED ABOVE SHALL APPLY TO ALL "NURSERY GROWN" PLANTS.
14. AT THE TIME OF FINAL INSPECTION ALL PLANTS SHALL BE IN A HEALTHY, VIGOROUS GROWING CONDITION, PLANTED IN FULL ACCORDANCE WITH DRAWINGS AND CONDITIONS.
15. SITE PLAN INFORMATION AS PER ASTRID J. CLOS PLANNING CONSULTANTS.
16. ENGINEERING AS PER GM BLUEPLAN ENGINEERING, AND IS PROVIDED FOR INFORMATION ONLY.
17. SITE LIGHTING BY OTHERS

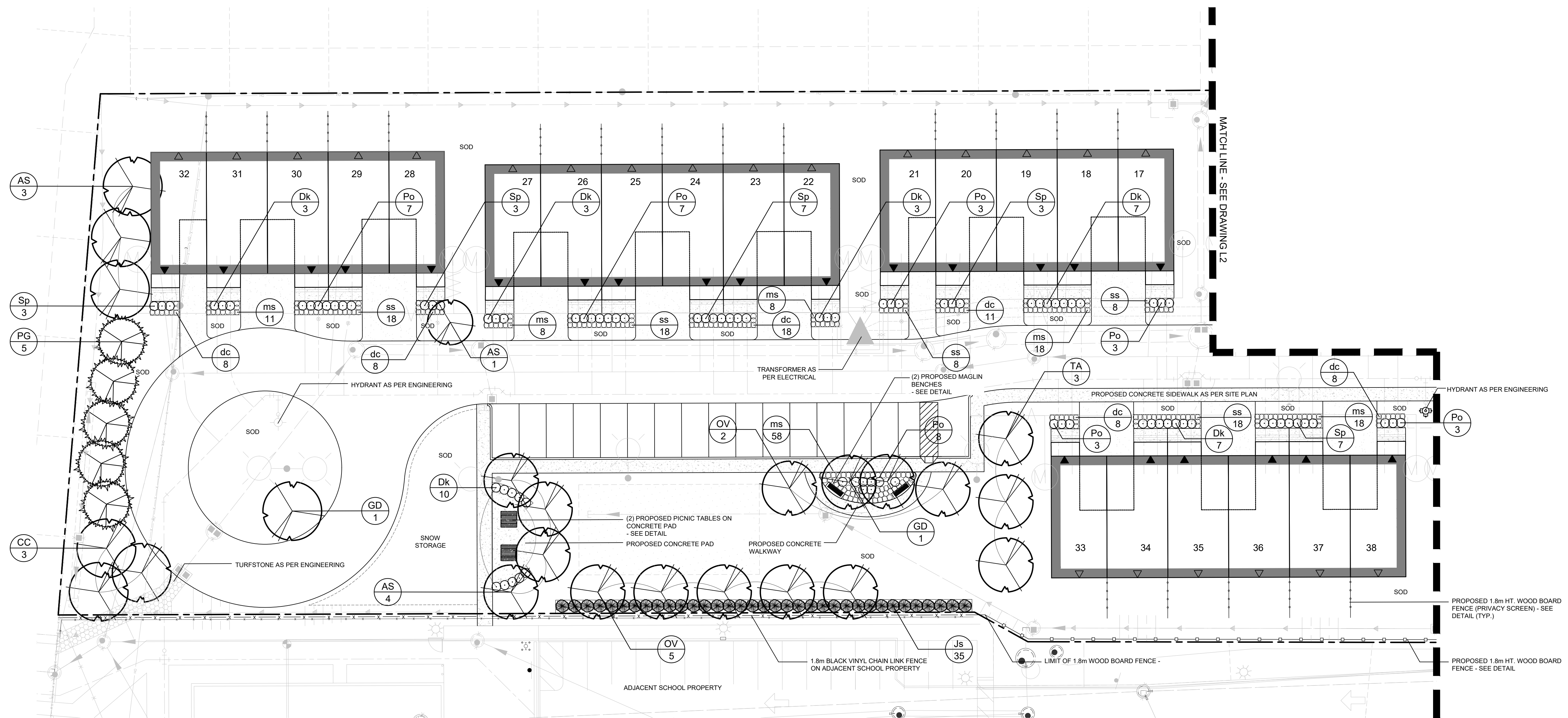

PLANT MATERIAL LIST - L1 ONLY

KEY	QUANT.	BOTANICAL NAME	COMMON NAME	SIZE	COND.
AS	8	Acer saccharum Autumn Fest	Autumn Fest Sugar Maple	70mm cal.	W.B.
CC	3	Cercis canadensis (tree form)	Eastern Redbud (tree form)	70mm cal.	W.B.
GD	2	Gymnocladus dioica	Kentucky Coffee Tree	70mm cal.	W.B.
OV	7	Ostrya virginiana	Ironwood	70mm cal.	W.B.
PG	5	Picea glauca	White Spruce	250cm ht.	W.B.
TA	3	Tilia americana	Basswood	70mm cal.	W.B.
Dk	33	Diervilla lonicera 'Kodiak Orange'	Kodiak Orange Bush Honeysuckle	60cm, 3 gal.	Pot
Po	34	Physocarpus opulifolius 'Dart's Gold'	Dart's Gold Ninebark	60cm, 3 gal.	Pot
Sp	23	Salix purpurea 'Nana'	Blue Arctic Willow	60cm, 3 gal.	Pot
Js	35	Juniperus sabina	Savin Juniper	60cm, 3 gal.	Pot
dc	61	Deschampsia cespitosa Gold Veil	Gold Veil Tufted Hair Grass	1 gal.	Pot
ms	121	Miscanthus sinensis 'Little Kitten'	Dwarf Maiden Grass	1 gal.	Pot
ss	70	Schizachyrium scoparium 'The Blues'	The Blues Little Bluestem	1 gal.	Pot

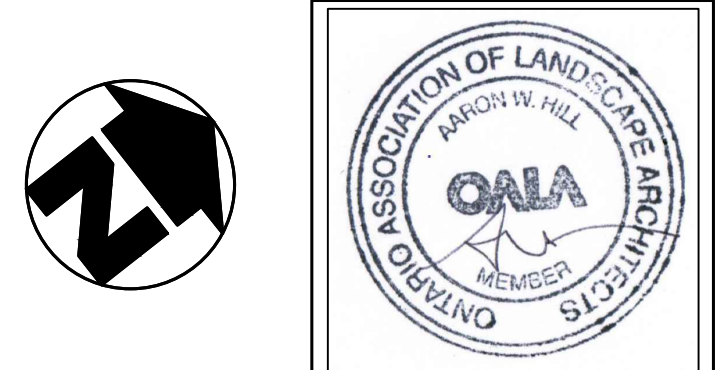

no.	date	description	by
1.	Sept.29.20	Issued for Client Review	CMH
2.	June.10.21	Issued for Approval	DPV

5150 Wellington Road 27  
North Rockwood Developments Inc.  
Guelph/Eramosa

**Landscape Plan**



PROJECT NO: 2020-43 DRAWN BY: DPV  
SCALE: 1:250 DESIGNED BY: DPV/AWH  
SHEET: APPROVED BY: AWH  
**L1** PLOT DATE: JUNE.10.2021

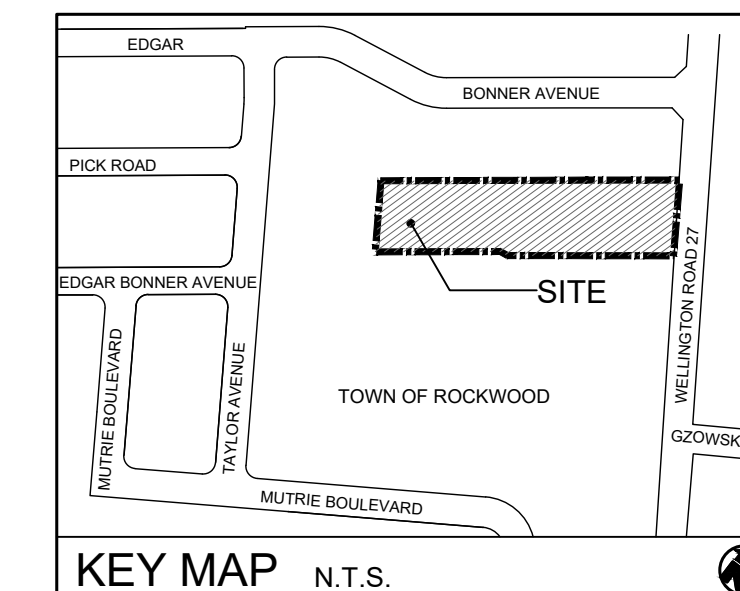

### GENERAL NOTES

1. ALL WORKMANSHIP WILL BE TO THE STANDARDS OF LANDSCAPE ONTARIO.
2. ALL PLANT MATERIAL TO BE NO. 1 GRADE NURSERY GROWN IN ACCORDANCE WITH THE CANADIAN STANDARDS FOR NURSERY STOCK, 9TH EDITION, 2017, BY THE CANADIAN NURSERY TRADES ASSOCIATION.
3. BACKFILL WILL CONSIST OF SOIL NATIVE TO THE SITE OR GENERAL SOIL TYPE/CLASS NATIVE TO THE SITE.
4. CONTRACTOR SHALL MAINTAIN ALL LANDSCAPE AREAS UNTIL OWNER'S ACCEPTANCE OF PROJECT.
5. CONTRACTOR TO LOCATE ALL UNDERGROUND UTILITIES.
6. PLANTING MAY BE ADJUSTED TO SUIT LOCATIONS OF SITE UTILITY STRUCTURES/SERVICES.
7. ALL MATERIALS MUST BE APPROVED BY LANDSCAPE ARCHITECT PRIOR TO INSTALLATION.
8. SPREAD MULCH TO A MINIMUM OF 100mm COMPACTED DEPTH ON ALL TREE FITS AND PLANTING BEDS.
9. CHECK AND VERIFY ALL DIMENSIONS AND QUANTITIES PRIOR TO COMMENCEMENT OF WORK. ANY DISCREPANCIES ARE TO BE REPORTED IN WRITING TO THE LANDSCAPE ARCHITECT. QUANTITIES NOTED WITHIN THE PLAN SUPERCEDE THOSE IN THE PLANT LIST. ANY SUBSTITUTIONS SHALL BE APPROVED BY THE LANDSCAPE ARCHITECT.
10. SOD AS MARKED WITH NURSERY SOD ON A MINIMUM OF 100mm OF CLEAN TOPSOIL, FINE GRADE AND SOD ALL SOULAVARD AREAS TO MUNICIPAL SPECIFICATIONS AND REPAIR DAMAGE TO ADJACENT PROPERTIES, AS REQUIRED.
11. FINAL INSPECTION AND ACCEPTANCE OF PLANTING WORK SHALL COINCIDE WITH THE FINAL INSPECTION AND ACCEPTANCE OF ALL WORK INCLUDED IN THE CONTRACT.
12. ALL SEEDED SLOPES 3:1 AND GREATER TO RECEIVE EROSION CONTROL MATTING. PIN SOD ON ALL SLOPES OF 3:1 OR GREATER.
13. SUBMIT A WRITTEN GUARANTEE TO THE EFFECT THAT ALL PLANTS ACCEPTED DURING THE PERIOD OF JANUARY 1st TO JULY 15th SHALL BE GUARANTEED UNTIL JULY 15th THE FOLLOWING YEAR. PLANTS ACCEPTED DURING THE PERIOD OF JULY 15th TO DECEMBER 31st SHALL BE GUARANTEED FOR ONE YEAR FROM THE DATE OF ACCEPTANCE. THE GUARANTEE PERIODS LISTED ABOVE SHALL APPLY TO ALL "NURSERY GROWN" PLANTS.
14. AT THE TIME OF FINAL INSPECTION ALL PLANTS SHALL BE IN A HEALTHY, VIGOROUS GROWING CONDITION, PLANTED IN FULL ACCORDANCE WITH DRAWINGS AND CONDITIONS.
15. SITE PLAN INFORMATION AS PER ASTRID J. CLOS PLANNING CONSULTANTS.
16. ENGINEERING AS PER GM BLUEPLAN ENGINEERING, AND IS PROVIDED FOR INFORMATION ONLY.
17. SITE LIGHTING BY OTHERS

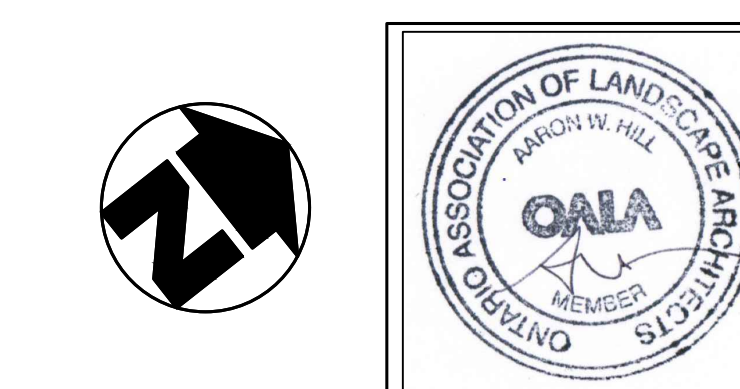

no.	date	description	by
1.	Sept.29.20	Issued for Client Review	CMH
2.	June.10.21	Issued for Approval	DPV

5150 Wellington Road 27  
North Rockwood Developments Inc.  
Guelph/Eramosa

### Landscape Plan



PROJECT NO: 2020-43	DRAWN BY: DPV
SCALE: 1:250	DESIGNED BY: DPV/AWH
SHEET:	APPROVED BY: AWH
PLOT DATE: JUNE.10.2021	

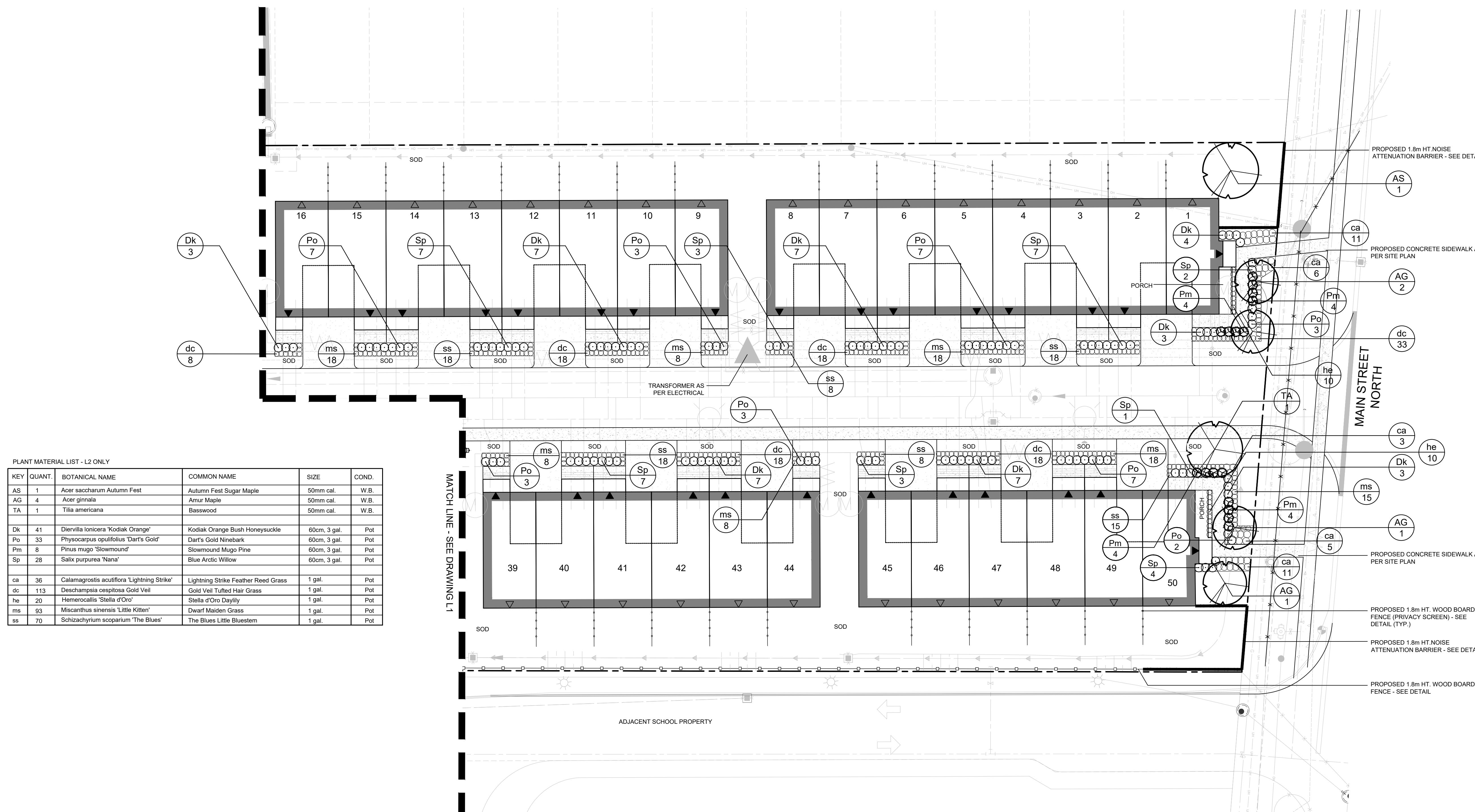

PLANT MATERIAL LIST - L2 ONLY

KEY	QUANT.	BOTANICAL NAME	COMMON NAME	SIZE	COND.
AS	1	Acer saccharum Autumn Fest	Autumn Fest Sugar Maple	50mm cal.	W.B.
AG	4	Acer ginnata	Amur Maple	50mm cal.	W.B.
TA	1	Tilia americana	Basswood	50mm cal.	W.B.
Dk	41	Diervilla lonicera 'Kodiak Orange'	Kodiak Orange Bush Honeysuckle	60cm, 3 gal.	Pot
Po	33	Physocarpus opulifolius 'Dart's Gold'	Dart's Gold Ninebark	60cm, 3 gal.	Pot
Pm	8	Pinus mugo 'Slowmound'	Slowmound Mugo Pine	60cm, 3 gal.	Pot
Sp	28	Salix purpurea 'Nana'	Blue Arctic Willow	60cm, 3 gal.	Pot
ca	36	Calamagrostis acutiflora 'Lightning Strike'	Lightning Strike Feather Reed Grass	1 gal.	Pot
dc	113	Deschampsia cespitosa Gold Veil	Gold Veil Tufted Hair Grass	1 gal.	Pot
he	20	Hemerocallis 'Stella d'Oro'	Stella d'Oro Daylily	1 gal.	Pot
ms	93	Miscanthus sinensis 'Little Kitten'	Dwarf Maiden Grass	1 gal.	Pot
ss	70	Schizachyrium scoparium 'The Blues'	The Blues Little Bluestem	1 gal.	Pot



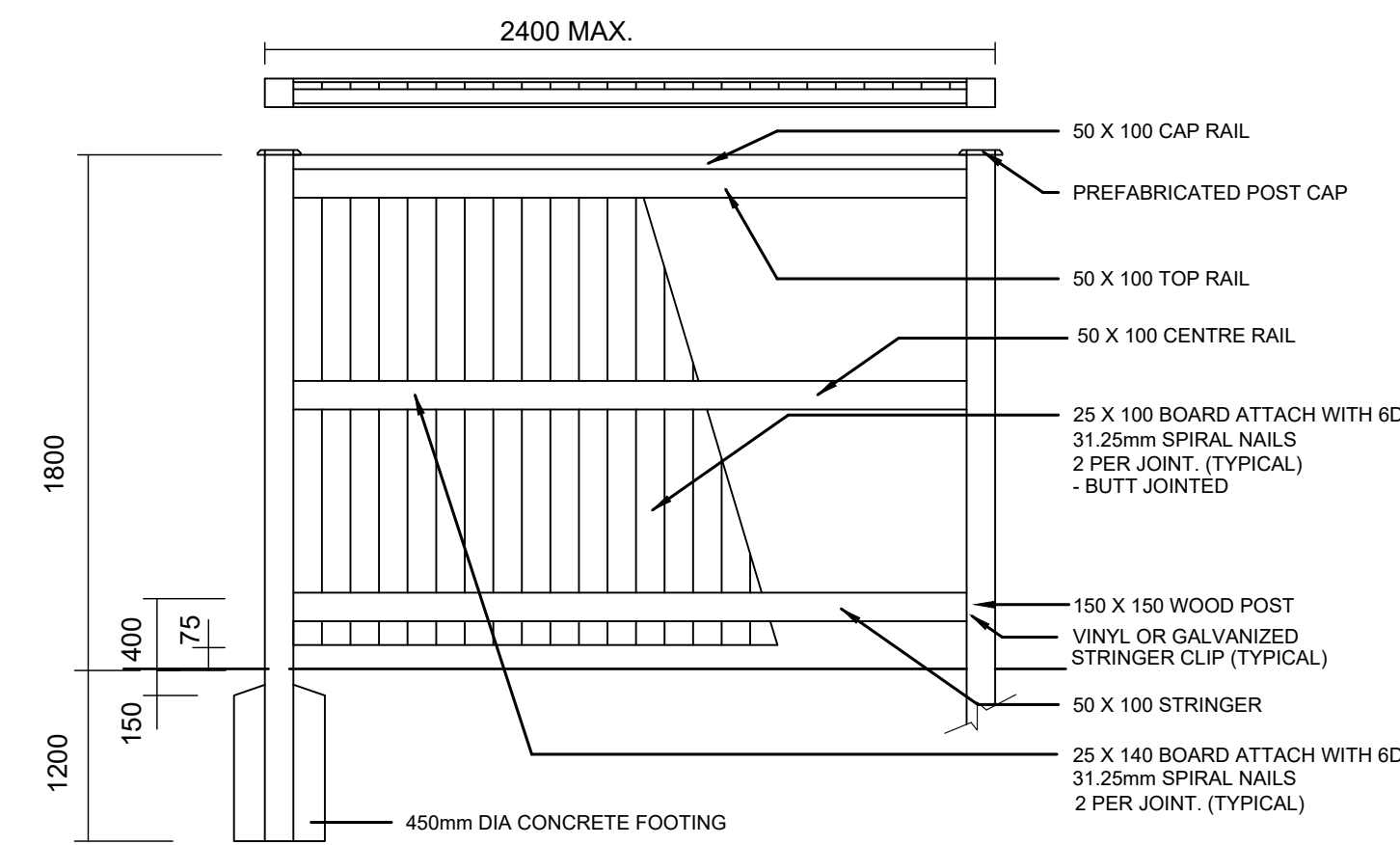

- NOTES
1. ALL CONSTRUCTION TO BE OF PRESSURE TREATED PINE
  2. ALL HARDWARE TO BE GALVANIZED
  3. ALL DIMENSIONS IN MILLIMETRES
  4. ALL PRESSURE TREATED CUTS TO BE DRESSED WITH COPPER NAPHANATE

6 1.8m HIGH WOOD BOARD FENCE DETAIL  
NTS

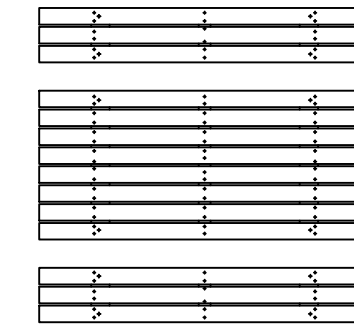
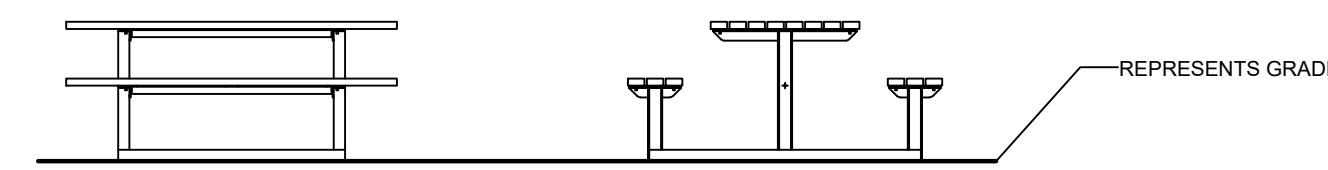

MACLIN PICNIC TABLE 1.800.716.5506  
MODEL - MLPT212R  
RECYCLED PLASTIC (COLOUR TBD), BLACK POWDERCOAT  
SURFACE MOUNT WITH STAINLESS STEEL BOLTS

7 PICNIC TABLE  
NTS

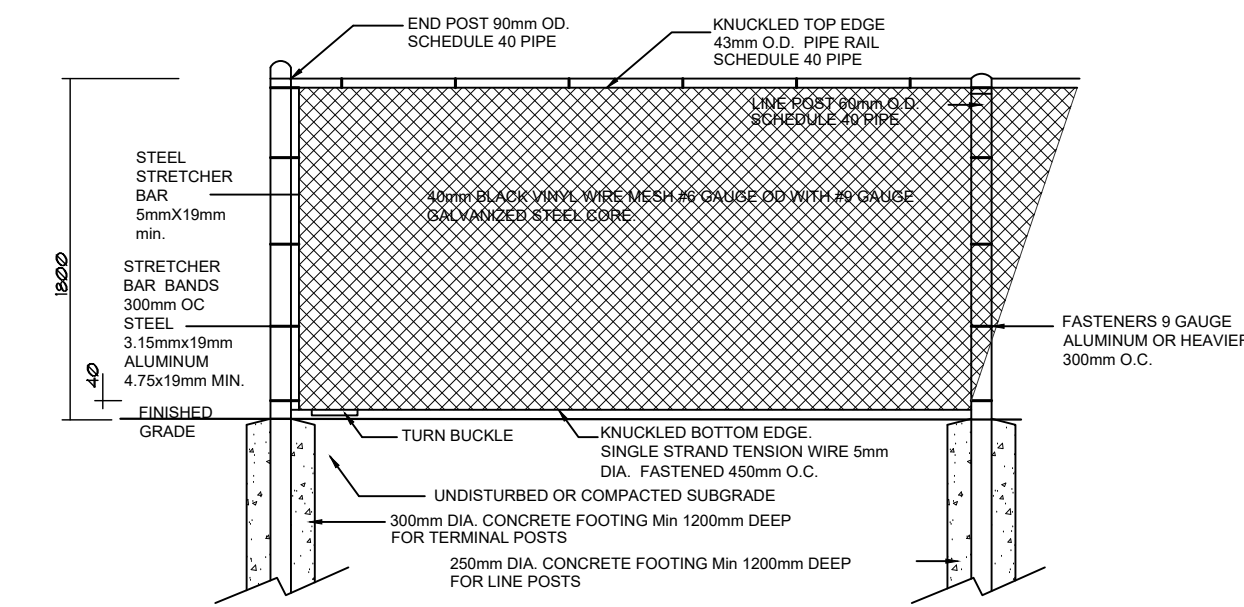

1.8m BLACK VINYL CHAINLINK FENCE

8 1.8m HIGH BLACK VINYL CHAINLINK FENCE DETAIL  
NTS

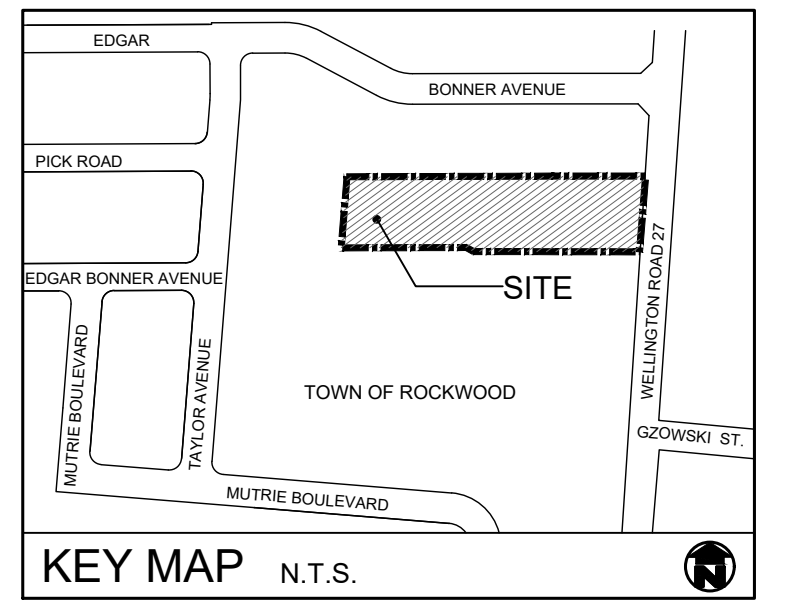

KEY MAP N.T.S.

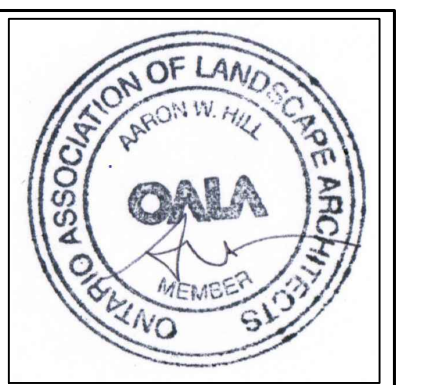

no.	date	description	by
1.	Sept.29.20	Issued for Client Review	CMH
2.	June.10.21	Issued for Approval	DPV

5150 Wellington Road 27  
North Rockwood Developments Inc.  
Guelph/Eramosa

Details



PROJECT NO: 2020-43 DRAWN BY: DPV  
SCALE: 1:250 DESIGNED BY: DPV/AWH  
SHEET: APPROVED BY: AWH  
L4 PLOT DATE: JUNE.10.2021