

CAUTION: THE POSITION OF POLE LINES, CONDUITS, WATERMANS, SEWERS AND OTHER UNDERGROUND AND OVERGROUND UTILITIES AND STRUCTURES IS NOT NECESSARILY SHOWN ON THE DRAWINGS, AND, WHERE SHOWN, THE ACCURACY OF THE POSITION OF SUCH UTILITIES AND STRUCTURES IS NOT GUARANTEED. BEFORE STARTING WORK, THE CONTRACTOR SHALL INFORM HIMSELF OF THE EXACT LOCATION OF ALL SUCH UTILITIES AND STRUCTURES, AND SHALL ASSUME ALL LIABILITY FOR DAMAGE TO THEM.

- Notes
1. TOPOGRAPHIC INFORMATION DERIVED FROM FIELD SURVEY BY TRITON ENGINEERING COMPLETED IN 2018.
  2. LOT FABRIC OF DERIVED FROM PLAN 61R-21276 PREPARED BY WILSON FORD SURVEYING ON FEBRUARY 14, 2018.

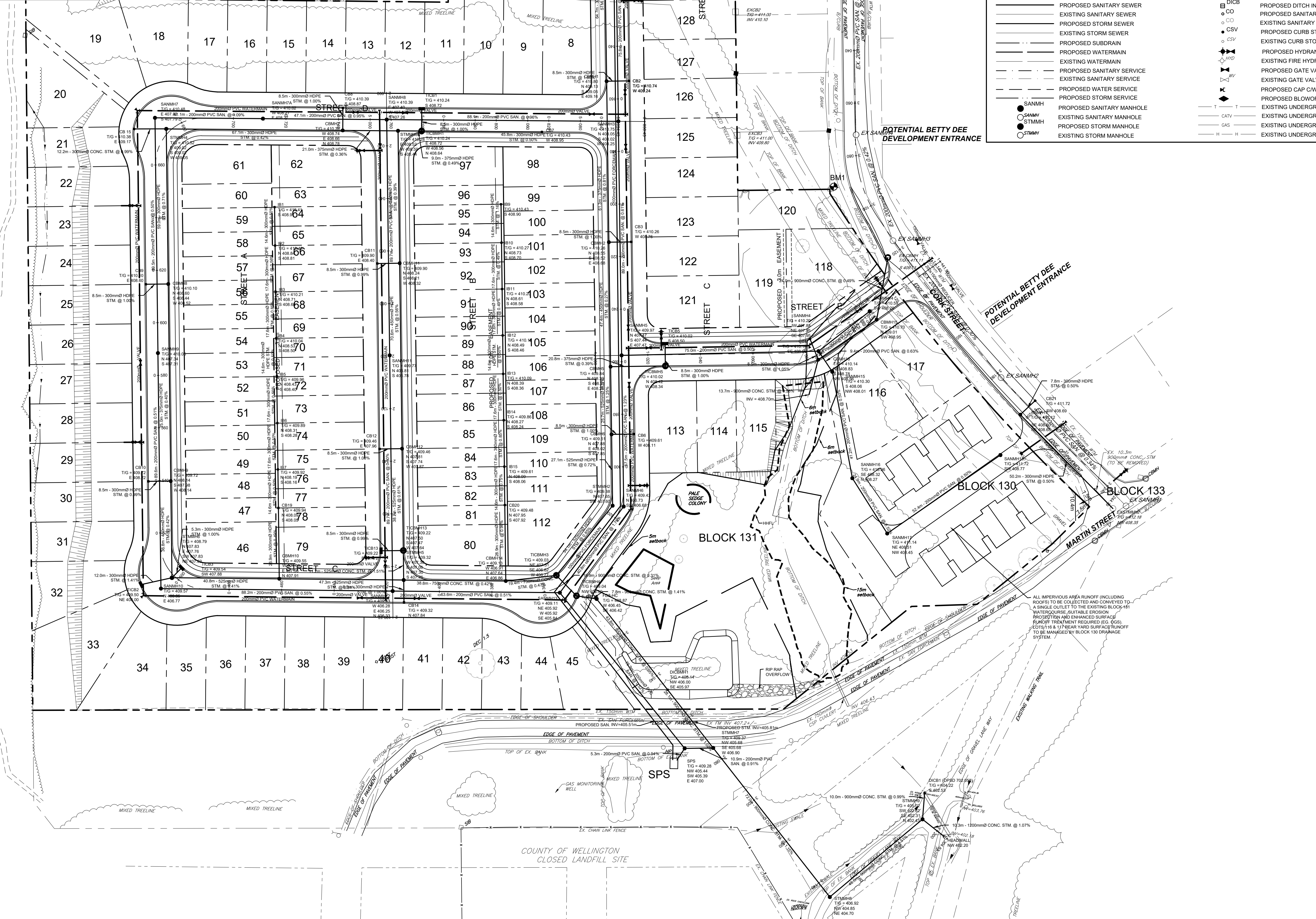

**LEGEND**

|   |                           |          |  |   |                             |
|---|---------------------------|----------|--|---|-----------------------------|
| — | SUBDIVISION BOUNDARY      | ○ CBMH   | PROPOSED CATCHBASIN MANHOLE            | — | EXISTING HYDRO GUY WIRE     |
| — | PROPOSED RIGHT OF WAY     | ○ TICBMH | PROPOSED TWIN INLET CATCHBASIN MANHOLE | — | EXISTING HYDRO POLE         |
| — | PROPOSED PROPERTY LINES   | □ TICB   | PROPOSED TWIN INLET CATCHBASIN         | — | EXISTING CABLE TV PEDESTAL  |
| — | EDGE OF EXISTING PAVEMENT | □ CB     | PROPOSED CATCH BASIN                   | — | EXISTING TELEPHONE PEDESTAL |
| — | EDGE OF EXISTING GRAVEL   | □ DICB   | EXISTING CATCH BASIN                   | — | STANDARD IRON BAR           |
| — | PROPOSED SANITARY SEWER   | ○ CO     | PROPOSED DITCH INLET CATCHBASIN        | — | IRON BAR                    |
| — | EXISTING SANITARY SEWER   | ○ CO     | PROPOSED SANITARY SERVICE CLEANOUT     | — | EXISTING DECIDUOUS TREE     |
| — | PROPOSED STORM SEWER      | ○ CSV    | EXISTING SANITARY SERVICE CLEANOUT     | — | EXISTING CONIFEROUS TREE    |
| — | EXISTING STORM SEWER      | ○ CSV    | PROPOSED CURB STOP VALVE               | — | EXISTING GAS MARKER         |
| — | PROPOSED SUBDRAIN         | ○ CSV    | PROPOSED BLOWOFF                       | — | EXISTING WELL               |
| — | PROPOSED WATERMAIN        | ○ CSV    | PROPOSED HYDRANT SET                   | — | EXISTING FIRE HYDRANT       |
| — | EXISTING WATERMAIN        | ○ CSV    | EXISTING CURB STOP VALVE               | — | EXISTING BENCHMARK          |
| — | PROPOSED SANITARY SERVICE | ○ CSV    | PROPOSED GATE VALVE                    | — | EXISTING BENCHMARK          |
| — | EXISTING SANITARY SERVICE | ○ CSV    | EXISTING GATE VALVE                    | — | BOREHOLE                    |
| — | PROPOSED WATER SERVICE    | ○ CSV    | PROPOSED CAP CW THRUST BLOCK           | — | PROPOSED ELEVATION          |
| — | PROPOSED SANITARY MANHOLE | ○ CSV    | PROPOSED BLOWOFF                       | — | EXISTING ELEVATION          |
| — | EXISTING SANITARY MANHOLE | ○ CSV    | EXISTING UNDERGROUND TELEPHONE CABLE   | — | DROP CURB                   |
| — | PROPOSED STORM MANHOLE    | ○ CSV    | EXISTING UNDERGROUND TV CABLE          | — |                             |
| — | EXISTING STORM MANHOLE    | ○ CSV    | GAS                                    | — |                             |
| — |                           | ○ CSV    | EXISTING UNDERGROUND GAS LINE          | — |                             |
| — |                           | ○ CSV    | EXISTING UNDERGROUND HYDRO CABLE       | — |                             |

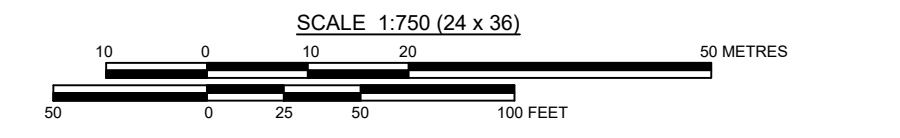

**Benchmark Information**

|     |  |         |
|-----|--|---------|
| BM1 | TOP OF SIB LOCATED ON THE WEST SIDE OF CORK STREET AT THE SOUTHEAST CORNER OF PART 12 PLAN 61R-21276 | 410.86m |
|-----|--|---------|

| No. | DATE       | DESCRIPTION                            | BY  | APPD |
|-----|------------|--|-----|------|
| 2   | OCT 14/22  | REVISED DRAFT PLAN APPROVAL SUBMISSION | TLB | TLB  |
| 1   | DEC 17/21  | REVISED DRAFT PLAN APPROVAL SUBMISSION | TLB | TLB  |
| 0   | SEPT 16/20 | DRAFT PLAN APPROVAL SUBMISSION         | TLB | TLB  |

REVISION / ISSUE

Seal not valid unless signed and dated

517 10th STREET Hanover, Ontario N4N 1R4  
Telephone: (519) 506-5959  
www.cobideeng.com

SUNVALE HOMES  
PROPOSED MOUNT FOREST SUBDIVISION  
Township of Wellington North  
CONCEPTUAL SERVICING PLAN

Client: **SUNVALE HOMES**

|          |          |           |       |
|----------|----------|-----------|-------|
| Design:  | TLB      | Scale:    | 1:750 |
| Drawn:   | TLB      | Approved: |       |
| Checked: | TLB      |           |       |
| Date:    | JAN 2019 |           |       |

DRAWING No. 00702-SP1

H:\Sunvale Homes\00702 Sunvale Homes Mount Forest Subdivision\Drawings\Submissions\2022-09-12 Third Submission\00702 Base 2022-07-06.dwg Oct 17, 2022 - 1:57pm