

# ALMA SUBDIVISION

## TOWNSHIP OF MAPLETON (ALMA)

CONTRACT 120139

EXACT CONSTRUCTION LTD.  
685 ST. DAVID STREET NORTH  
FERGUS, ON



330 TRILLIUM DRIVE, UNIT D  
KITCHENER, ON

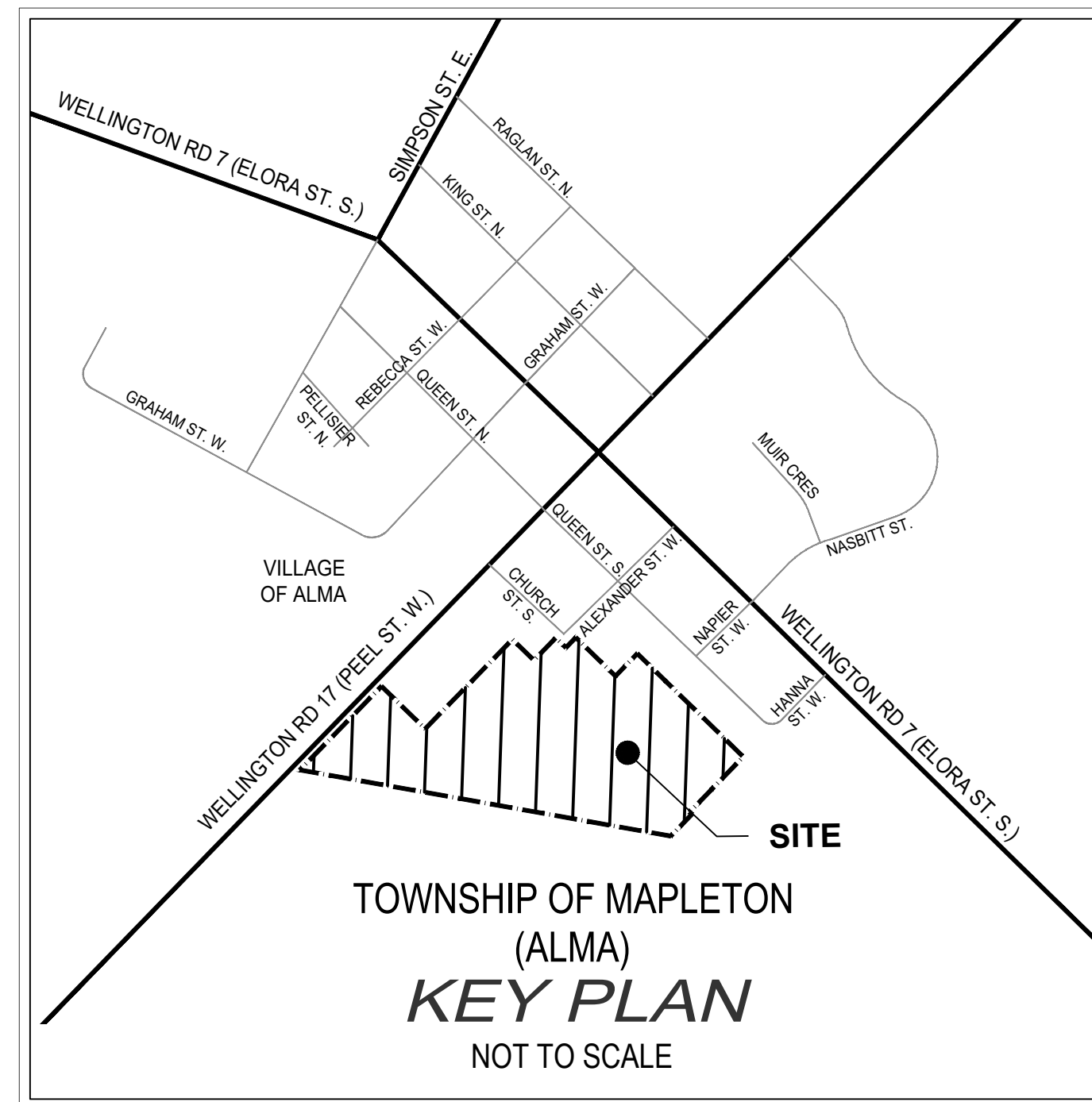

INDEX	
DWG. No.	DESCRIPTION
1	EXISTING CONDITIONS AND REMOVALS PLAN
2	CONCEPTUAL SERVICING PLAN
3	CONCEPTUAL GRADING PLAN 1 OF 3
4	CONCEPTUAL GRADING PLAN 2 OF 3
5	CONCEPTUAL GRADING PLAN 3 OF 3
6	CONCEPTUAL STORMWATER MANAGEMENT PLAN
7	PROPOSED SWALE PLAN AND PROFILE
8	CONCEPTUAL EROSION AND SEDIMENT CONTROL PLAN
9	DETAILS AND SECTIONS PLAN

FILE: E:\Development\120139 - Alma Subdivision\120139 - Cover.dwg, LAYOUT COVER  
LAST SAVED BY: E:\Users\120139\_10\120139\_10.DWG, FACETED BY: Armstrong, Erin, 01/20/24 2:23:23 PM



**LEGEND**

- PROPERTY LINE
- EX. SANITARY SEWER
- EX. STORM SEWER
- EX. WATERMAIN
- EX. DITCH
- EX. BELL LINE
- EX. GAS LINE
- EX. FENCE LINE
- EX. CONTOURS
- EX. CATCH BASIN
- EX. FIRE HYDRANT
- EX. LIGHT STANDARD
- HEDGE
- CONIFEROUS/DECIDUOUS TREES
- GRCA FLOODPLAIN ELEVATION (OBTAINED FROM THE GRCA, DATED 2020-12-09)
- GRCA REGULATION LIMIT (OBTAINED FROM THE GRCA, DATED 2020-12-09)
- WATERCOURSE 10M BUFFER (OBTAINED FROM NATURAL RESOURCE SOLUTIONS INC., DATED 2022-08-16)
- BOREHOLE/MONITORING WELL
- PROPOSED STORM SEWER
- STIM
- SEWER
- PROPOSED FINISHED GRADE
- INVERT OF SEWER
- WELL WITH 15m SETBACK
- EX. TREES TO REMAIN

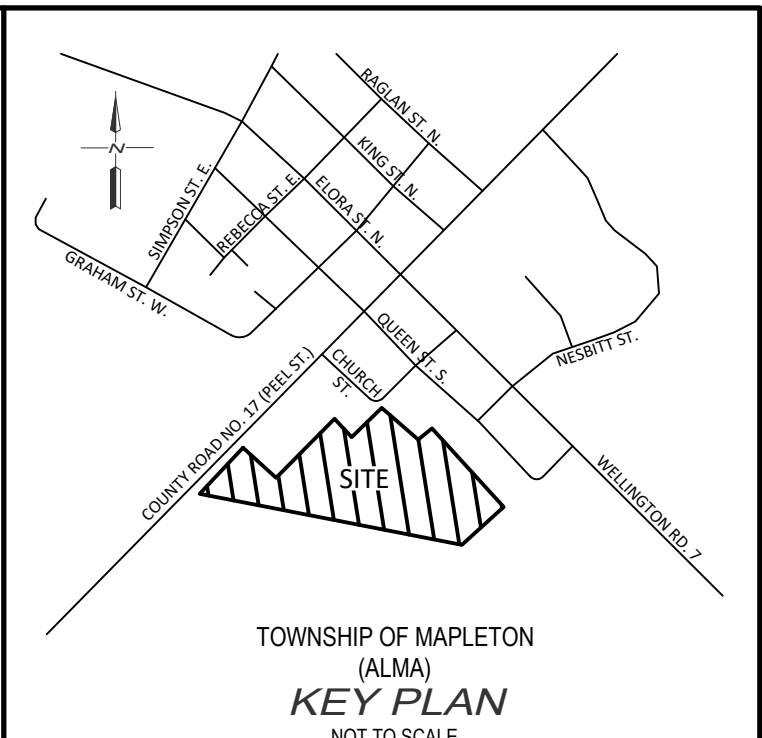
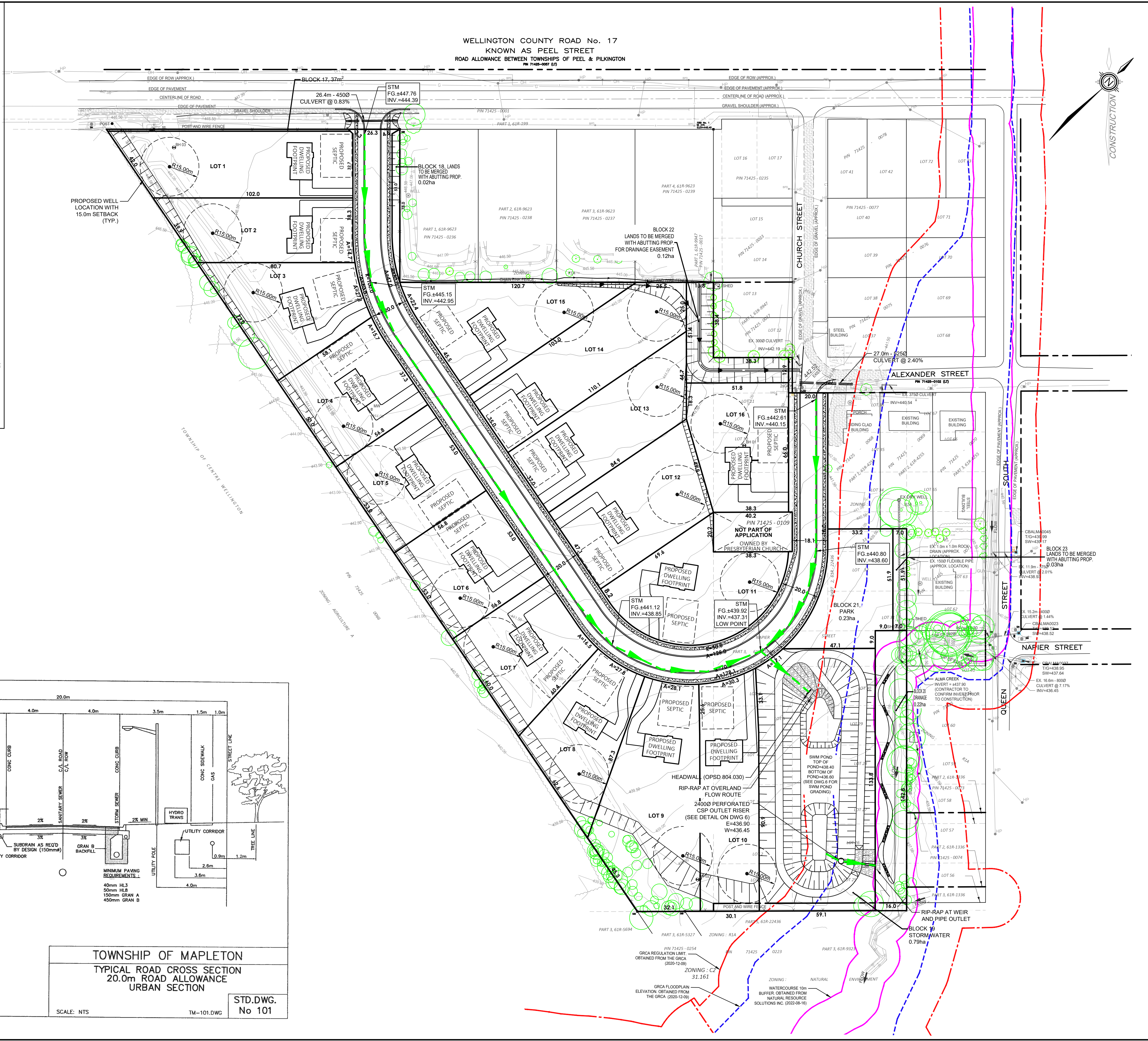

- NOTES :**
1. EXISTING CONDITIONS AND TOPOGRAPHIC INFORMATION PROVIDED BY VAN HARTEN SURVEYING INC. COMPLETED ON SEPTEMBER 09, 2022.
  2. EXISTING TREE LOCATIONS PROVIDED BY NATURAL RESOURCE SOLUTIONS INC. DATED NOVEMBER 23, 2022.
  3. GEOTECHNICAL INFORMATION PROVIDED BY CMT ENGINEERING INC. DATED DECEMBER 16, 2020.
  4. EXISTING HYDRO INFORMATION PROVIDED BY HYDRO ONE ON AUGUST 24, 2022.
  5. GRCA REGULATION INFORMATION OBTAINED FROM THE GRAND RIVER CONSERVATION AUTHORITY.
  6. EXISTING GAS INFORMATION PROVIDED BY ENBRIDGE ON AUGUST 27, 2022.
  7. EXISTING BELL CABLE LINE INFORMATION PROVIDED BY BELL CANADA ON SEPTEMBER 08, 2022.
  8. DRAFT PLAN PROVIDED BY VAN HARTEN SURVEYING INC. DATED SEPTEMBER 05, 2024.
  9. PROPOSED DWELLING AND SEPTIC BED LAYOUTS OBTAINED FROM VAN HARTEN SURVEYING INC. REPORT 'SEWAGE SYSTEM & WATER SUPPLY CONSULTATION' DATED SEPTEMBER 29, 2023.
  10. SEASONAL HIGH GROUNDWATER CONTOURS PROVIDED BY HYDROGEOLOGY CONSULTING SERVICES INC. RECEIVED SEPTEMBER 26, 2022.
  11. EXISTING ROCK DRILL LOCATION OBTAINED FROM GMSBY AND MANNEROW LIMITED DRAWING 'NAPIER STREET - ROAD RECONSTRUCTION' REV 2 (JAN 1994) AND JOHN VANDERWELLES MARK UPS RECEIVED ON FEBRUARY 03, 2023. LOCATION IS APPROXIMATE AND CONTRACTOR IS TO CONFIRM LOCATION PRIOR TO CONSTRUCTION.

**BENCH MARKS :**

SITE BENCHMARK:  
ELEV = 445.40  
IB 375 ON NORTHWEST CORNER OF LOT 1, CONCESSION 1, WEST OF THE GRAND RIVER.

THE POSITION OF POLE LINES, CONDUITS, WATERMANS, SEWERS AND OTHER UNDERGROUND AND OVERGROUND UTILITIES AND STRUCTURES IS NOT NECESSARILY SHOWN ON THE CONTRACT DRAWINGS AND, WHERE SHOWN, THE ACCURACY OF THE POSITION OF SUCH UTILITIES AND STRUCTURES IS NOT GUARANTEED.

BEFORE STARTING WORK, THE CONTRACTOR SHALL INFORM HIMSELF OF THE EXACT LOCATION OF ALL SUCH UTILITIES AND STRUCTURES, AND SHALL ASSUME ALL LIABILITY FOR ANY DAMAGE TO THEM.

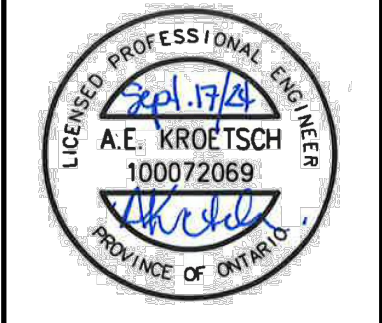

NO.	DATE	REVISION DESCRIPTION	CHKD
5.	2024/09/17	REVISED PER UPDATED DRAFT PLAN	A.E.K.
4.	2024/02/27	UPDATED SWM DESIGN AND ISSUED FOR APPROVAL	A.E.K.
3.	2023/10/12	REVISED PER UPDATED DRAFT PLAN AND ISSUED FOR APPROVAL	A.E.K.
2.	2023/10/02	ISSUED FOR APPROVAL	A.E.K.
1.	2023/06/02	ISSUED FOR REVIEW	A.E.K.

**BluePlan**  
ENGINEERING

GUELPH | OWEN SOUND | LISTOWEL | WITBENER | LONDON | HAMILTON | GTA  
330 TRILLIUM DRIVE, UNIT D, KITCHENER, ON N2E 3J2  
TEL 519-748-1440 www.blueplan.ca

**ALMA SUBDIVISION**

**EXACT CONSTRUCTION LTD**

**TOWNSHIP OF MAPLETON**

**CONCEPTUAL SERVICING PLAN**

DRAWN BY: E.A.	APPROVED BY: A.E.K.	PROJECT NO. : 120139	DRAWING NO. : 2
DESIGNED BY: A.E.K.	DATE : AUGUST 2022	SCALE : 1:1000	

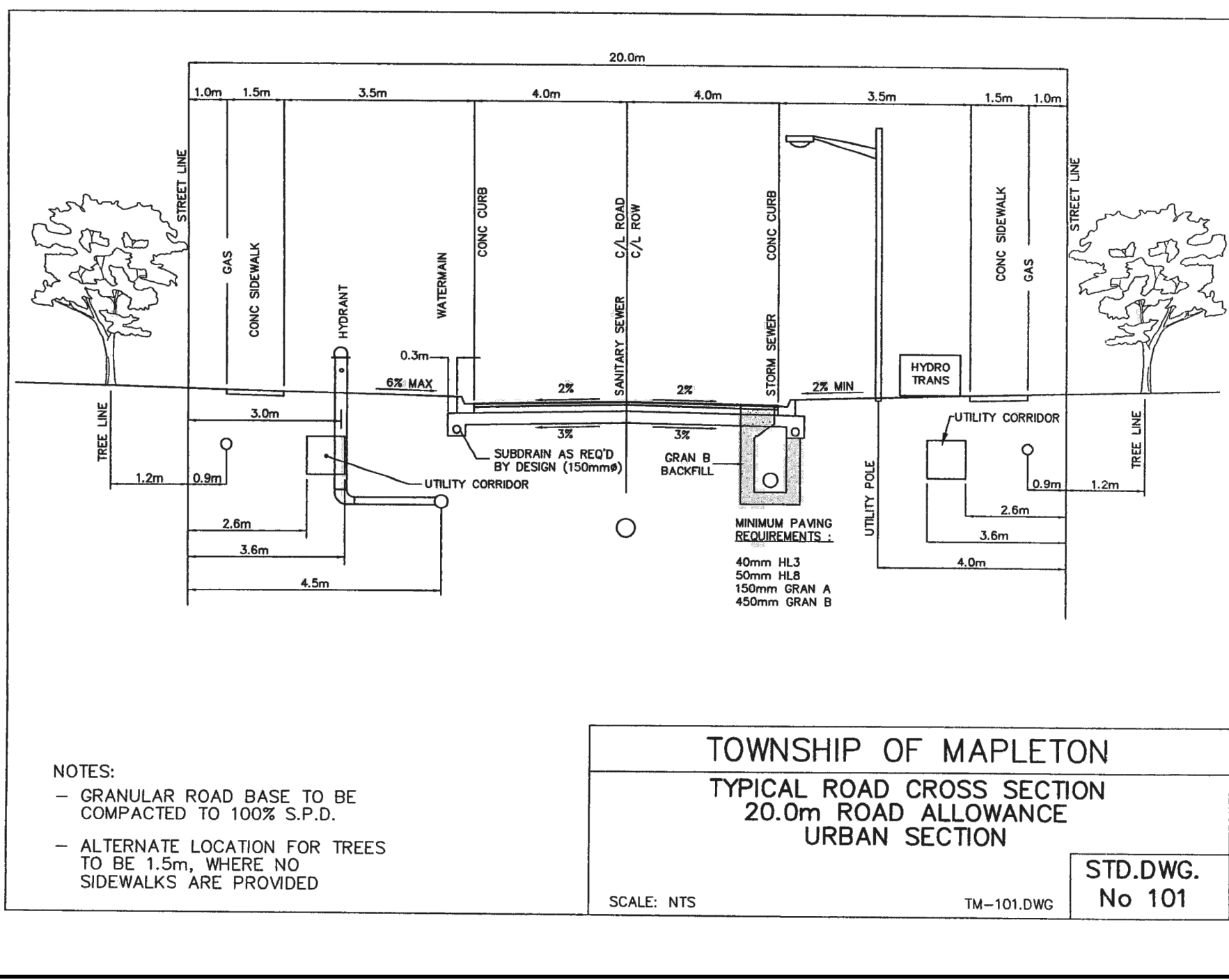

FILE: R:\Projects\2024\09\17\ALMA Subdivision\Drawings\Conceptual Servicing Plan.dwg  
LISTED BY: E.A. KROETSCH, P. ENG. (100072069)  
LAST SAVED BY: E.A. KROETSCH, P. ENG. (100072069) ON: 2024/09/17 10:22:00 AM







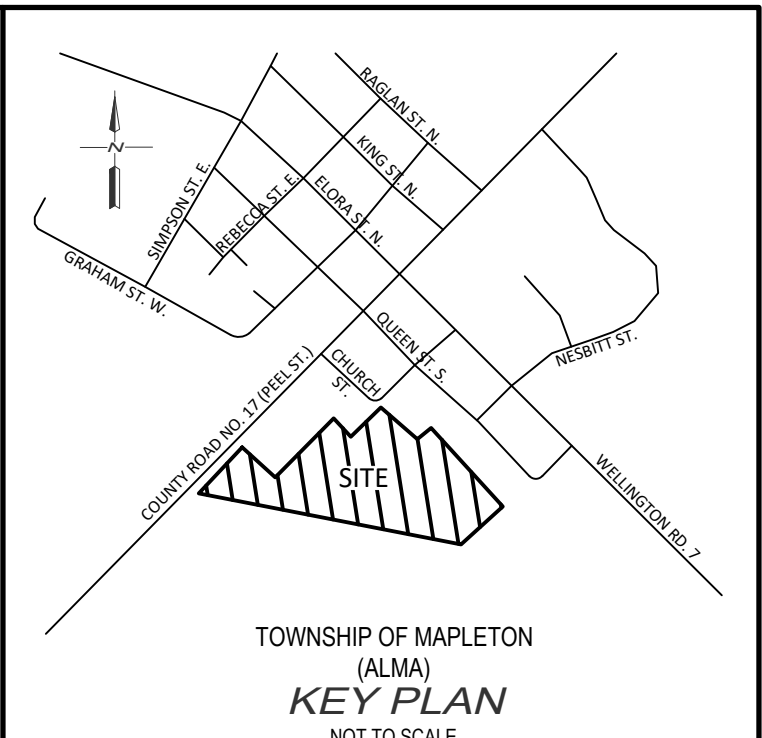
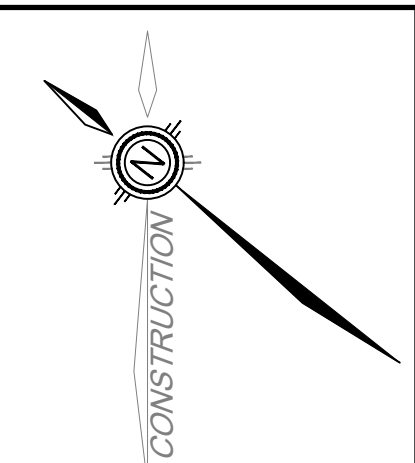

- NOTES :**
- EXISTING CONDITIONS AND TOPOGRAPHIC INFORMATION PROVIDED BY VAN HARTEN SURVEYING INC. COMPLETED ON SEPTEMBER 09, 2022.
  - EXISTING TREE LOCATIONS PROVIDED BY NATURAL RESOURCE SOLUTIONS INC. DATED NOVEMBER 23, 2022.
  - GEOTECHNICAL INFORMATION PROVIDED BY CMT ENGINEERING INC. DATED DECEMBER 10, 2020.
  - EXISTING HYDRO INFORMATION PROVIDED BY HYDRO ONE ON AUGUST 24, 2022.
  - GRCA REGULATION INFORMATION OBTAINED FROM THE GRAND RIVER CONSERVATION AUTHORITY.
  - EXISTING GAS INFORMATION PROVIDED BY ENBRIDGE ON AUGUST 27, 2022.
  - EXISTING BELL CABLE LINE INFORMATION PROVIDED BY BELL CANADA ON SEPTEMBER 08, 2022.
  - DRAFT PLAN PROVIDED BY VAN HARTEN SURVEYING INC. DATED SEPTEMBER 05, 2024.
  - PROPOSED DWELLING AND SEPTIC BED LAYOUTS OBTAINED FROM VAN HARTEN SURVEYING INC. REPORT "SEWAGE SYSTEM & WATER SUPPLY CONSULTATION" DATED SEPTEMBER 29, 2023.
  - SEASONAL HIGH GROUNDWATER CONTOURS PROVIDED BY HYDROGEOLOGY CONSULTING SERVICES INC. RECEIVED SEPTEMBER 26, 2022.
  - EXISTING ROCK DRAIN LOCATION OBTAINED FROM GAMBYS AND MANNEROW LIMITED DRAWING "NAPIER STREET - ROAD RECONSTRUCTION" REV 2 (JAN 1994) AND JOHN VANDERWELLES MARK-UPS RECEIVED ON FEBRUARY 03, 2023. LOCATION IS APPROXIMATE AND CONTRACTOR IS TO CONFIRM LOCATION PRIOR TO CONSTRUCTION.

**BENCH MARKS :**

SITE BENCHMARK:  
ELEV = 445.40  
IB 375 ON NORTHWEST CORNER OF LOT 1, CONCESSION 1, WEST OF THE GRAND RIVER.

THE POSITION OF POLE LINES, CONDUITS, WATERMANS, SEWERS AND OTHER UNDERGROUND AND OVERGROUND UTILITIES AND STRUCTURES IS NOT NECESSARILY SHOWN ON THE CONTRACT DRAWINGS, AND, WHERE SHOWN, THE ACCURACY OF THE POSITION OF SUCH UTILITIES AND STRUCTURES IS NOT GUARANTEED.

BEFORE STARTING WORK, THE CONTRACTOR SHALL INFORM HIMSELF OF THE EXACT LOCATION OF ALL SUCH UTILITIES AND STRUCTURES, AND SHALL ASSUME ALL LIABILITY FOR ANY DAMAGE TO THEM.

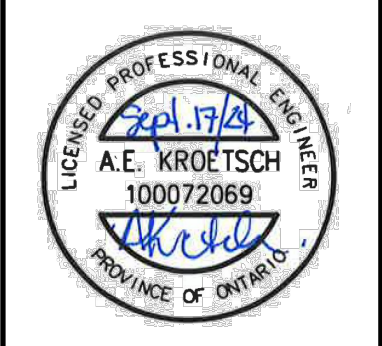

NO.	DATE	REVISION DESCRIPTION	CHKD
5.	2024/09/17	REVISED PER UPDATED DRAFT PLAN	A.E.K.
4.	2024/02/27	UPDATED SWM DESIGN AND ISSUED FOR APPROVAL	A.E.K.
3.	2023/10/12	REVISED PER UPDATED DRAFT PLAN AND ISSUED FOR APPROVAL	A.E.K.
2.	2023/10/02	ISSUED FOR APPROVAL	A.E.K.
1.	2023/06/02	ISSUED FOR REVIEW	A.E.K.



ALMA SUBDIVISION

EXACT CONSTRUCTION LTD

TOWNSHIP OF MAPLETON

CONCEPTUAL STORMWATER MANAGEMENT PLAN

DRAWN BY:	APPROVED BY:	PROJECT NO.:	DRAWING NO.:
E.A.	A.E.K.	120139	6
DESIGNED BY:	DATE:	SCALE:	
A.E.K.	AUGUST 2022	AS NOTED	

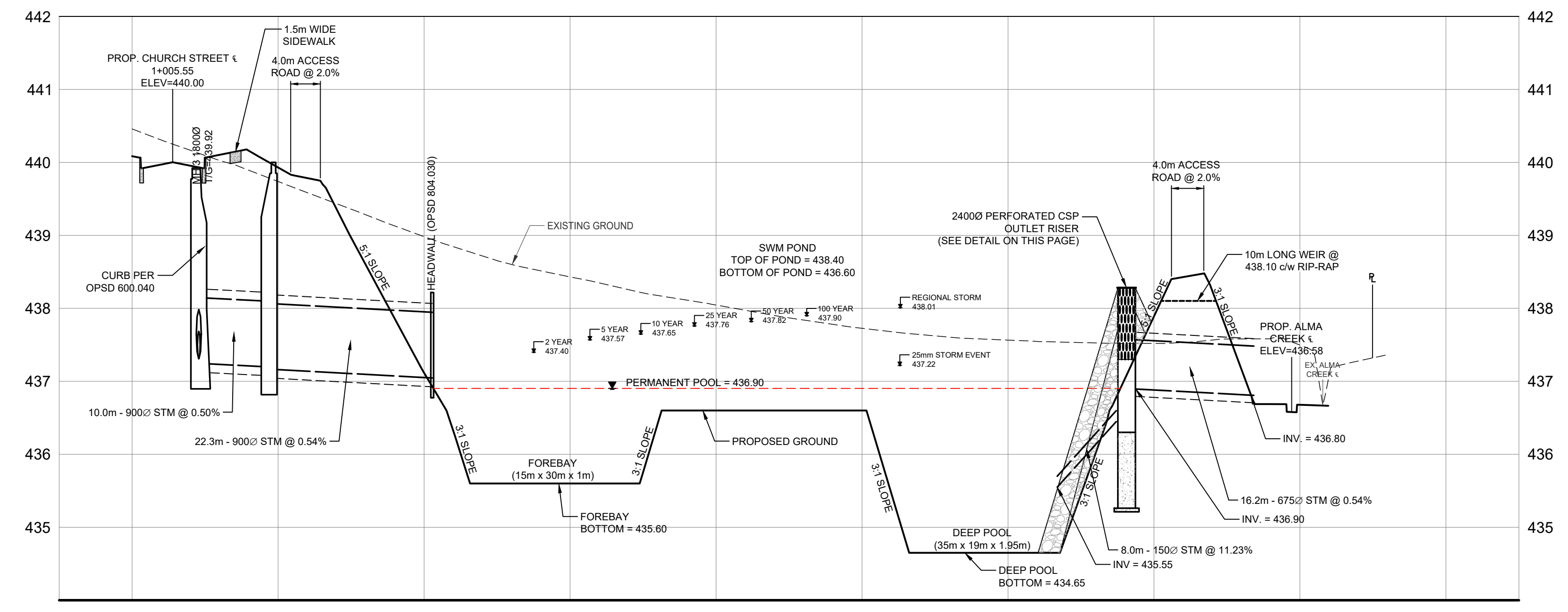
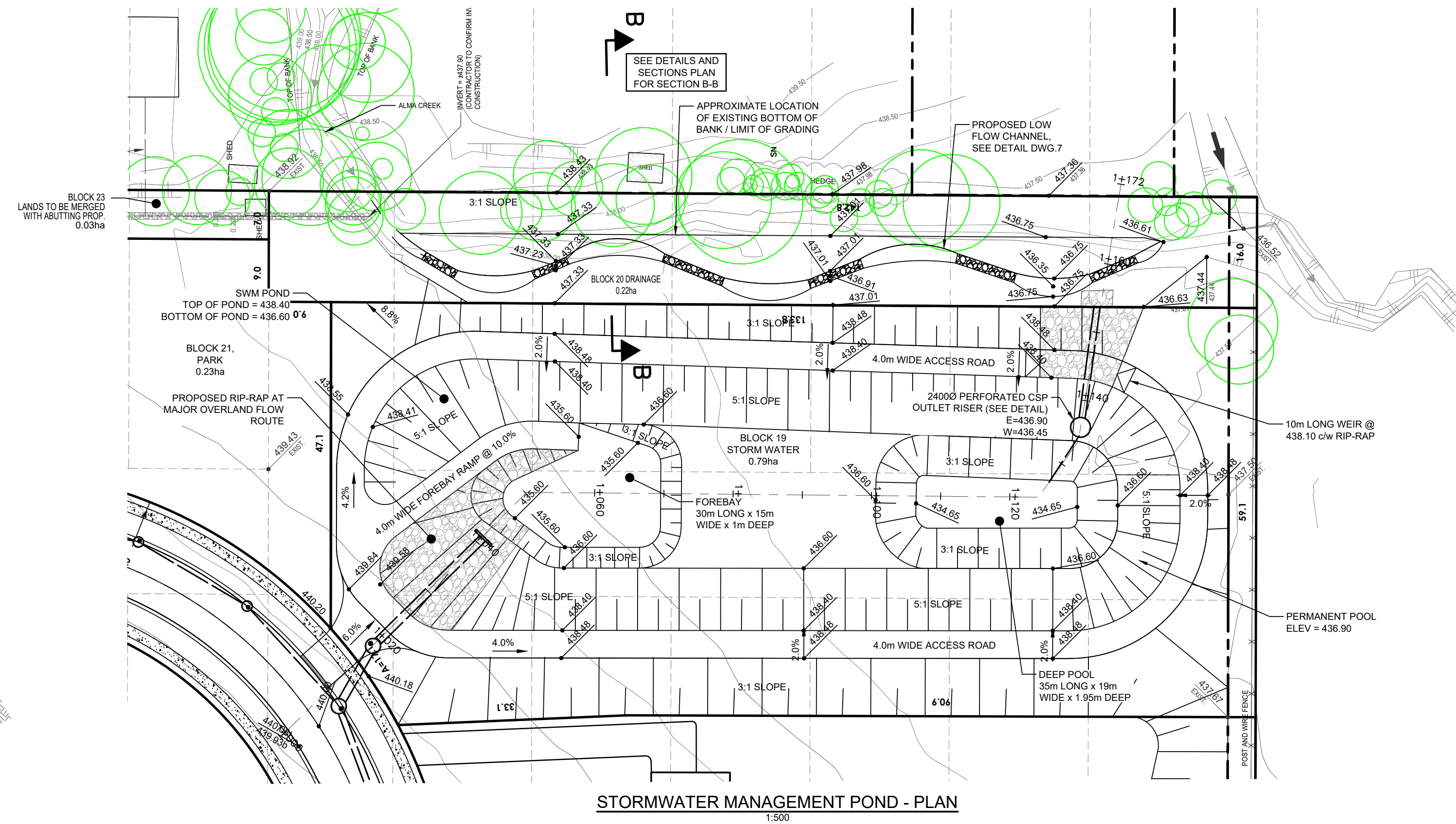
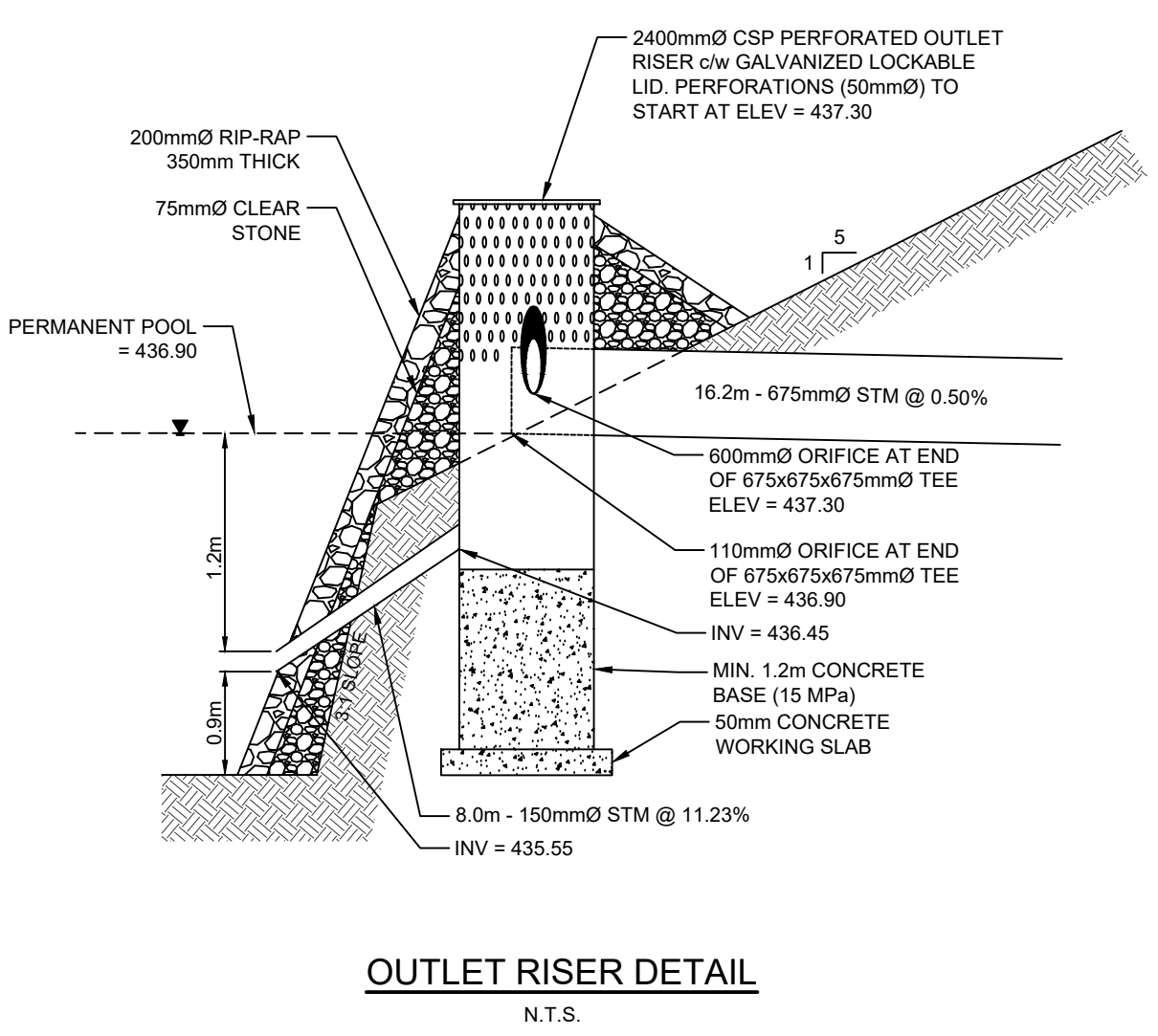
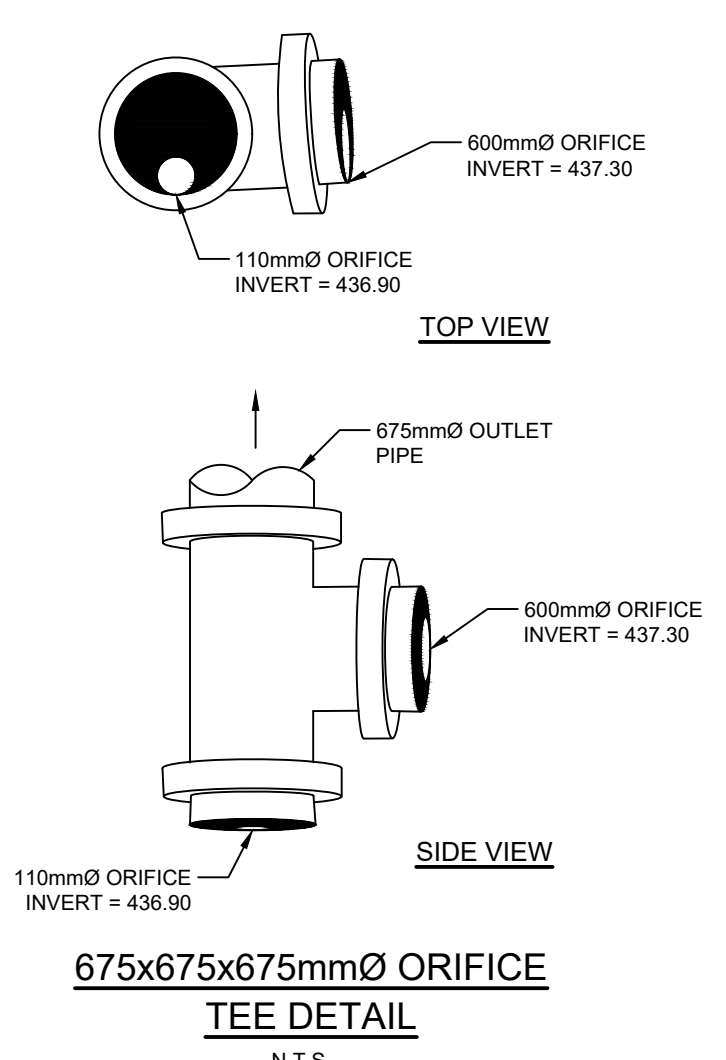

**LEGEND**

	PROPERTY LINE		PROPOSED GRADE		PROPOSED GRADE
	EX. SANITARY SEWER		EXISTING GRADE		PROP. TOP OF CURB
	EX. STORM SEWER		TOP OF WALL GRADE		PROP. BOTTOM OF CURB
	EX. WATERMAIN		BOTTOM OF WALL GRADE		PROPOSED SWALE GRADE
	EX. DITCH		MAJOR OVERLAND FLOW		
	EX. BELL LINE				
	EX. GAS LINE				
	EX. FENCE LINE				
	EX. CATCH BASIN				
	EX. FIRE HYDRANT				
	EX. LIGHT STANDARD				
	HEDGE				
	CONIFEROUS/DECIDUOUS TREES				

FILE: R:\Projects\2024\240000\240000\_Stormwater Management Plan.dwg  
 LAST SAVED BY: E.A. (2024/08/22 11:33:44 AM) PLOTTED BY: A.A. (2024/08/22 11:33:44 AM)

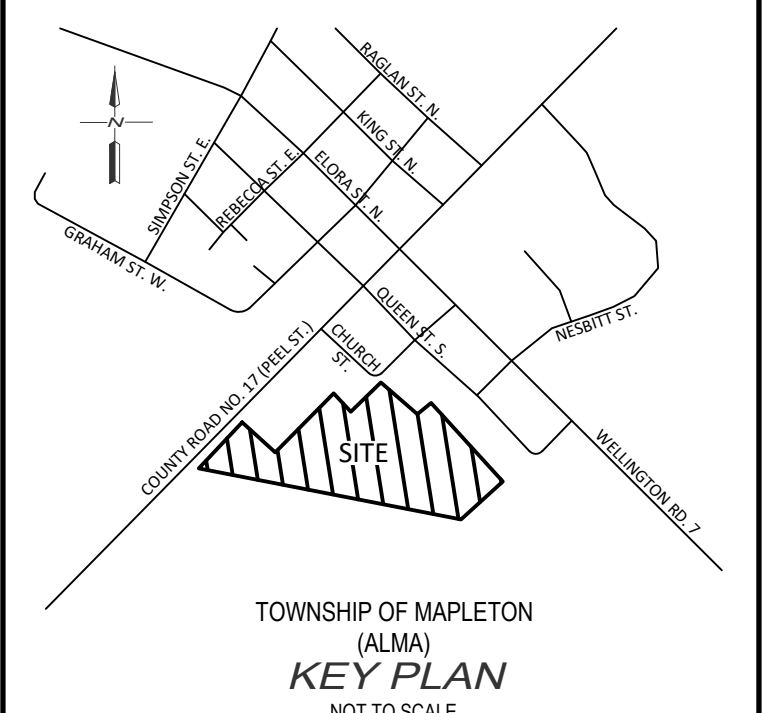
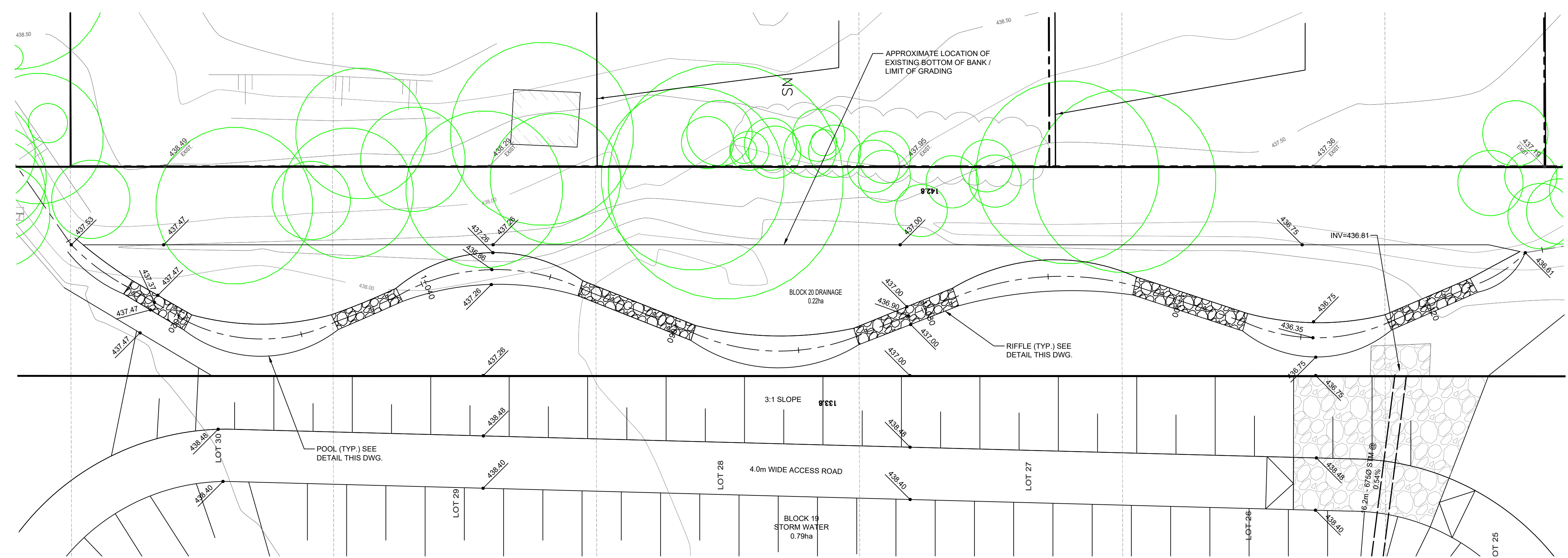

- NOTES :**
- EXISTING CONDITIONS AND TOPOGRAPHIC INFORMATION PROVIDED BY VAN HARTEN SURVEYING INC. COMPLETED ON SEPTEMBER 09, 2022.
  - EXISTING TREE LOCATIONS PROVIDED BY NATURAL RESOURCE SOLUTIONS INC. DATED NOVEMBER 23, 2022.
  - GEOTECHNICAL INFORMATION PROVIDED BY CMT ENGINEERING INC. DATED DECEMBER 18, 2020.
  - EXISTING HYDRO INFORMATION PROVIDED BY HYDRO ONE ON AUGUST 24, 2022.
  - GRCA REGULATION INFORMATION OBTAINED FROM THE GRAND RIVER CONSERVATION AUTHORITY.
  - EXISTING GAS INFORMATION PROVIDED BY ENBRIDGE ON AUGUST 27, 2022.
  - EXISTING BELL CABLE LINE INFORMATION PROVIDED BY BELL CANADA ON SEPTEMBER 08, 2022.
  - DRAFT PLAN PROVIDED BY VAN HARTEN SURVEYING INC. DATED SEPTEMBER 05, 2024.
  - PROPOSED DWELLING AND SEPTIC BED LAYOUTS OBTAINED FROM VAN HARTEN SURVEYING INC. REPORT "SEWAGE SYSTEM & WATER SUPPLY CONSULTATION" DATED SEPTEMBER 29, 2023.
  - SEASONAL HIGH GROUNDWATER CONTOURS PROVIDED BY HYDROGEOLOGY CONSULTING SERVICES INC. RECEIVED SEPTEMBER 26, 2022.
  - EXISTING ROCK DRAIN LOCATION OBTAINED FROM GANSBY AND MANNEROW LIMITED DRAWING "NAPIER STREET - ROAD RECONSTRUCTION" REV 2 (JAN 1994) AND JOHN VANDERWELLES MARK-UPS RECEIVED ON FEBRUARY 03, 2023. LOCATION IS APPROXIMATE AND CONTRACTOR IS TO CONFIRM LOCATION PRIOR TO CONSTRUCTION.

**BENCH MARKS :**

SITE BENCHMARK:  
ELEV = 445.40  
IB 375 ON NORTHWEST CORNER OF LOT 1, CONCESSION 1, WEST OF THE GRAND RIVER.

THE POSITION OF POLE LINES, CONDUITS, WATERMANS, SEWERS AND OTHER UNDERGROUND AND OVERGROUND UTILITIES AND STRUCTURES IS NOT NECESSARILY SHOWN ON THE CONTRACT DRAWINGS, AND, WHERE SHOWN, THE ACCURACY OF THE POSITION OF SUCH UTILITIES AND STRUCTURES IS NOT GUARANTEED.

BEFORE STARTING WORK, THE CONTRACTOR SHALL INFORM HIMSELF OF THE EXACT LOCATION OF ALL SUCH UTILITIES AND STRUCTURES, AND SHALL ASSUME ALL LIABILITY FOR ANY DAMAGE TO THEM.

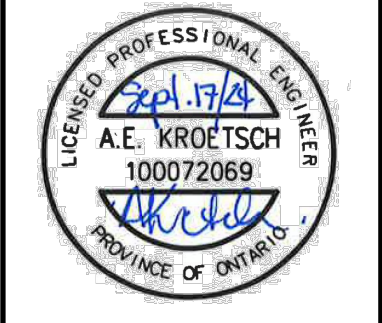

NO.	DATE	REVISION DESCRIPTION	CHKD
5.	2024/09/17	REVISED PER UPDATED DRAFT PLAN	A.E.K.
4.	2024/02/27	UPDATED SWM DESIGN AND ISSUED FOR APPROVAL	A.E.K.
3.	2023/10/12	REVISED PER UPDATED DRAFT PLAN AND ISSUED FOR APPROVAL	A.E.K.
2.	2023/10/02	ISSUED FOR APPROVAL	A.E.K.
1.	2023/06/02	ISSUED FOR REVIEW	A.E.K.



ALMA SUBDIVISION  
EXACT CONSTRUCTION LTD  
TOWNSHIP OF MAPLETON  
**PROPOSED SWALE PLAN AND PROFILE**

DRAWN BY: E.A.	APPROVED BY: A.E.K.	PROJECT NO.: 120139	DRAWING NO.: <b>7</b>
DESIGNED BY: A.E.K.	DATE: AUGUST 2022	SCALE: H 1:200 V 1:20	

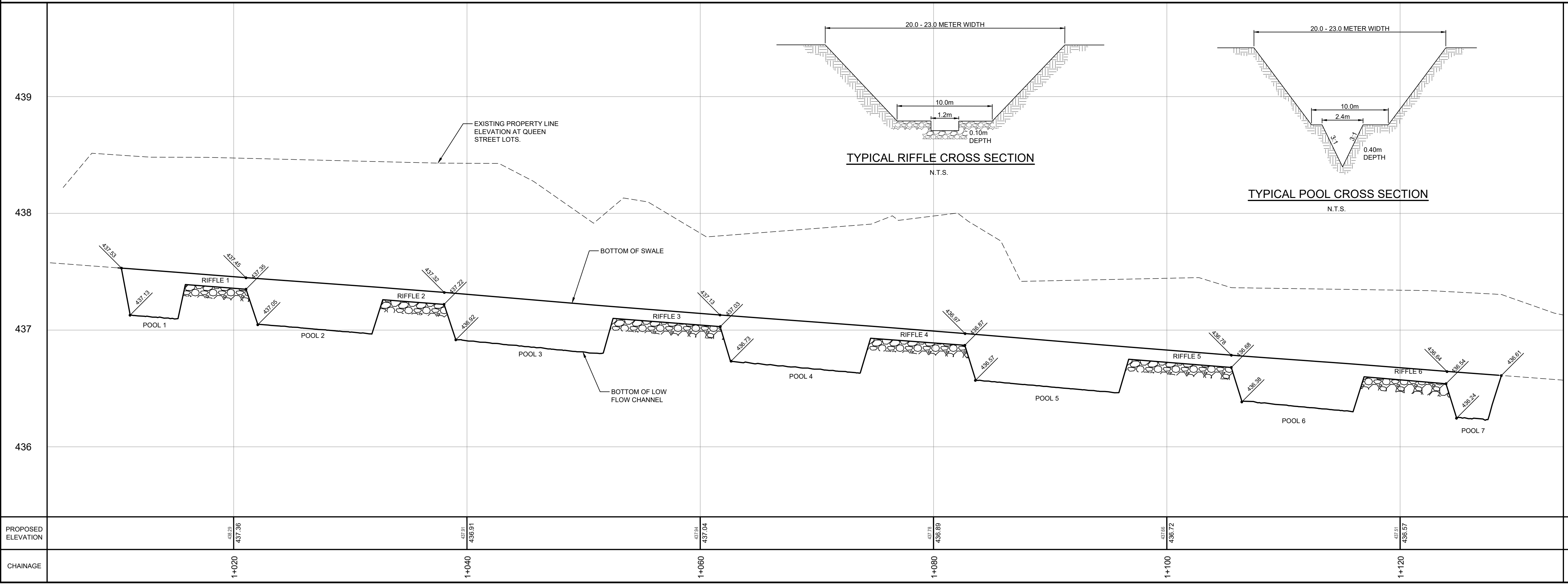

FILE: R:\Projects\2024\240001\240001.dwg - 240001.dwg - 240001.dwg - 240001.dwg - 240001.dwg - 240001.dwg - 240001.dwg - 240001.dwg - 240001.dwg - 240001.dwg  
 LAST SAVED BY: E.A. - 2024/08/28 11:33:33 AM - PLOTTED BY: A.E.K. - 2024/08/28 11:33:33 AM

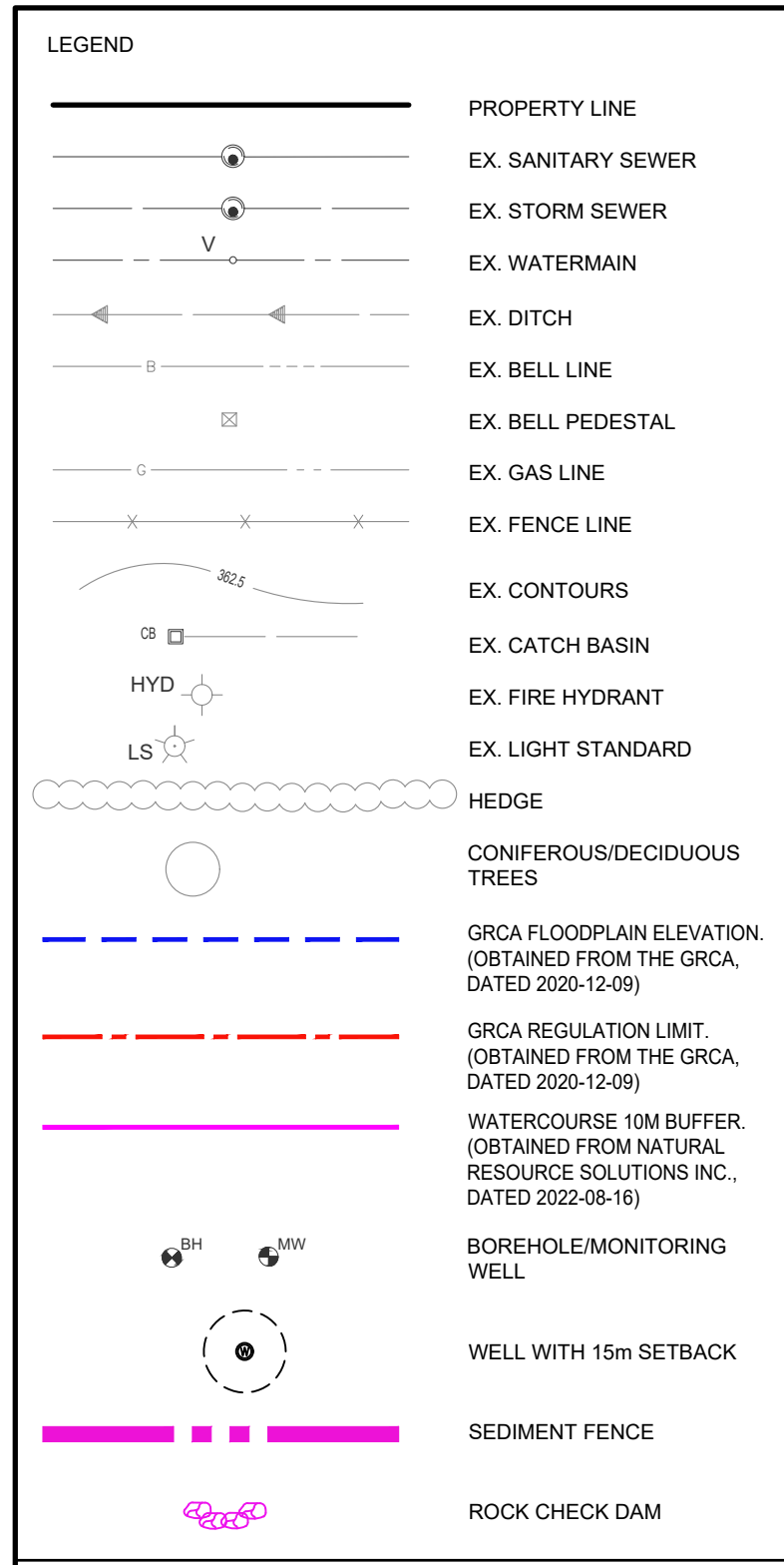

**SEDIMENT AND EROSION CONTROL NOTES**

- SITE WORKS ARE TO BE STAGED IN SUCH A MANNER THAT EROSION WILL BE MINIMIZED AND THAT BARRIERS AND SEDIMENTATION FACILITIES WITHIN THE SITE ARE PROVIDED TO CONTROL ANY EROSION THAT DOES OCCUR.
- PRIOR TO THE ISSUANCE OF A BUILDING PERMIT, A SEDIMENT POND OR STORAGE AREA MUST BE ESTABLISHED TO COLLECT SURFACE DRAINAGE FROM ALL AREAS THAT WILL BE DISTURBED. WATER PUMPED FROM EXCAVATION OR DEWATERING OPERATIONS MUST BE DIRECTED TO THE SEDIMENT POND.
- ALL SILT FENCING IS TO BE INSTALLED PRIOR TO THE COMMENCEMENT OF ANY GRADING EXCAVATION OR DEMOLITION.
- CLEARING AND GRUBBING OF THE SITE SHOULD BE KEPT TO A MINIMUM AND VEGETATION REMOVED ONLY IN ADVANCED OF IMMEDIATE CONSTRUCTION.
- STOCKPILES OF EARTH OR TOPSOIL ARE TO BE LOCATED AND PROTECTED TO MINIMIZE ENVIRONMENTAL INTERFERENCE. STOCKPILES SHOULD NOT BE LOCATED IMMEDIATELY ADJACENT TO DITCHES OR ROAD ALLOWANCES. EROSION CONTROL FENCING IS TO BE INSTALLED AROUND THE BASE OF ALL STOCKPILES. A PERIMETER DITCH LEADING TO A SETTLING AREA OR SEDIMENTATION TRAP SHOULD BE INSTALLED AROUND THE STOCKPILE.
- EROSION PROTECTION TO BE PROVIDED AROUND ALL STORM AND SANITARY MANHOLES CATCH BASINS, DITCHES SWALES AND WATERCOURSES.
- ADDITION EROSION CONTROL MEASURES MAY BE REQUIRED AS SITE DEVELOPMENT PROGRESSES. THE CONTRACTOR IS TO PROVIDE ALL ADDITIONAL EROSION CONTROL STRUCTURES.
- THE DESIGN CONSULTANT IS TO MONITOR EROSION CONTROL STRUCTURES TO ENSURE FENCING IS INSTALLED AND MAINTENANCE IS PERFORMED TO CITY REQUIREMENTS.
- EROSION CONTROL STRUCTURES ARE TO BE MONITORED REGULARLY AND ANY DAMAGE TO STRUCTURES REPAIRED IMMEDIATELY. SEDIMENTS ARE TO BE REMOVED WHEN ACCUMULATIONS REACH A MAXIMUM OF 50% OF THE FENCE. CLOGGED FILTER MATERIALS SUCH AS CRUSHED STONE, STRAW BALES OR FILTER CLOTH MUST BE REPLACED AS REQUIRED.
- ALL EROSION CONTROL STRUCTURES ARE TO REMAIN IN PLACE UNTIL ALL DISTURBED GROUND SURFACES HAVE BEEN STABILIZED EITHER BY PAVING OR RESTORATION OF VEGETATIVE GROUND COVER.
- NO ALTERNATIVE METHODS OF EROSION PROTECTION SHALL BE PERMITTED UNLESS APPROVED BY THE DESIGN CONSULTANT AND THE TOWNSHIP.
- THE CONTRACTOR IS RESPONSIBLE TO ENSURE THAT MUNICIPAL ROADWAYS AND SIDEWALKS AREA CLEANED OF ALL SEDIMENTS FROM VEHICULAR TRACKING ETC. TO AND FROM THE SITE AT THE END OF EACH WORK DAY.
- ALL DISTURBED AREAS NOT INCLUDED IN CONSTRUCTION TO BE RE-TOPSOILED AND RE-SEEDED IMMEDIATELY AFTER COMPLETION OF AREA GRADING.

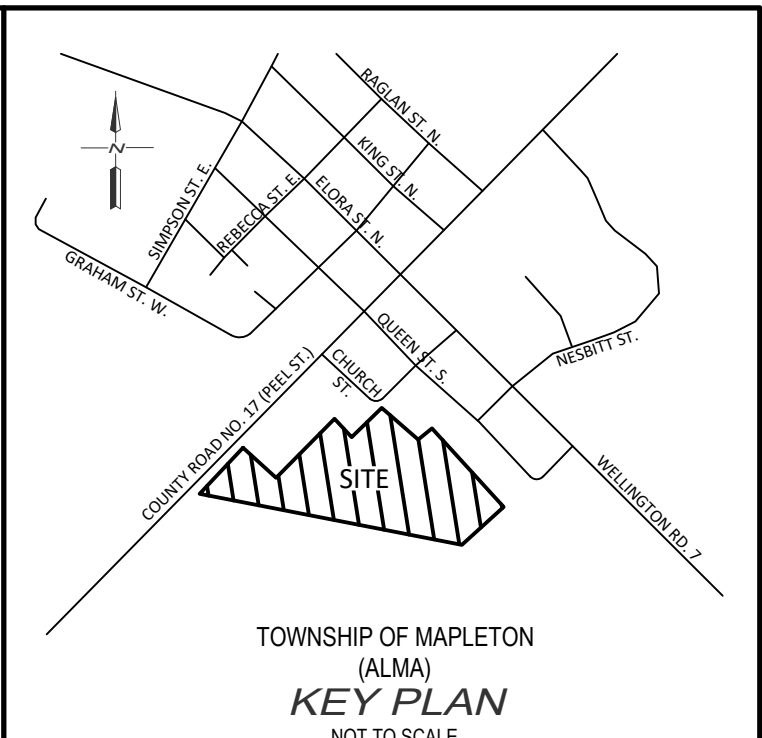
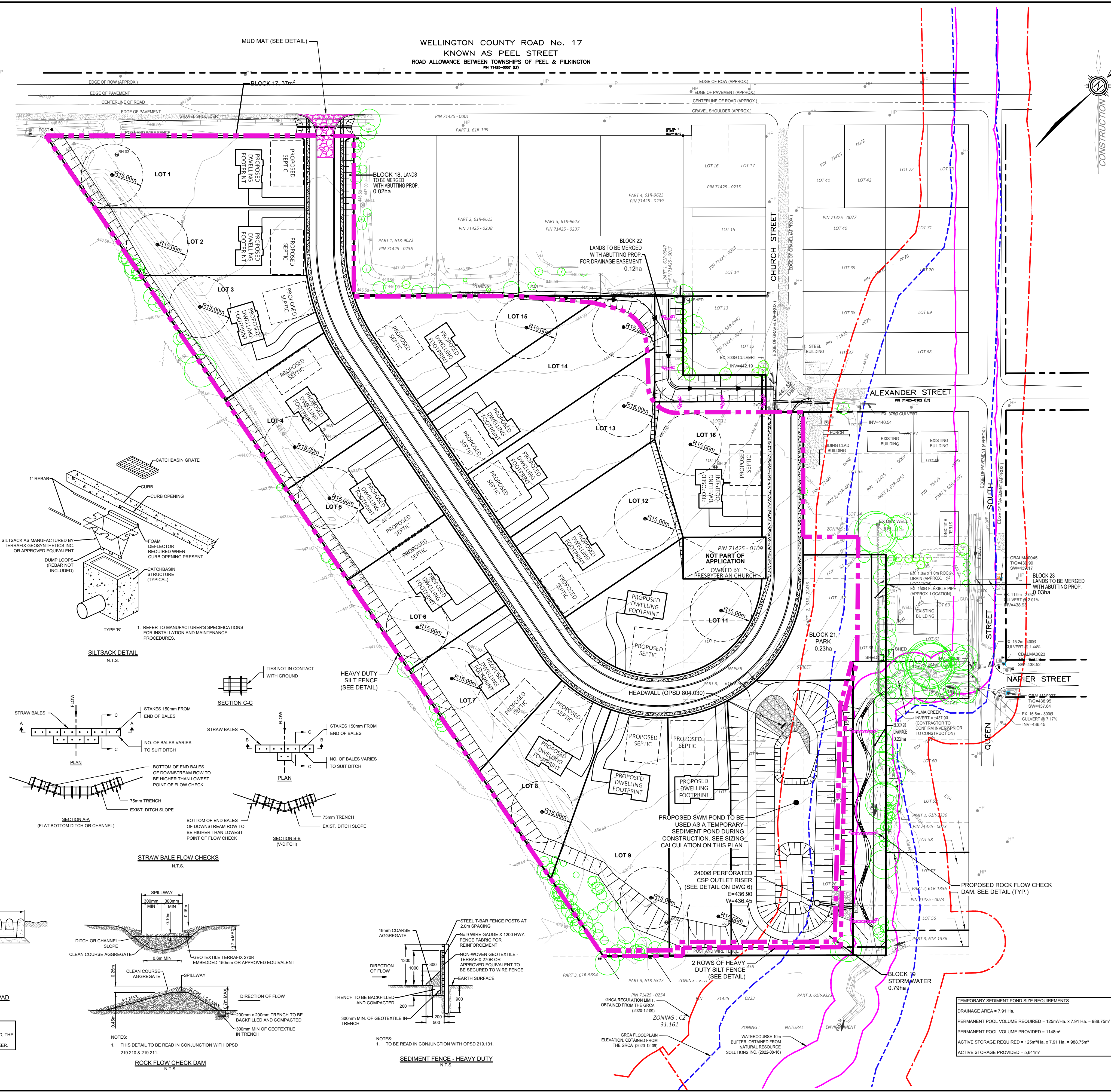

- NOTES :**
- EXISTING CONDITIONS AND TOPOGRAPHIC INFORMATION PROVIDED BY VAN HARTEN SURVEYING INC. COMPLETED ON SEPTEMBER 09, 2022.
  - EXISTING TREE LOCATIONS PROVIDED BY NATURAL RESOURCE SOLUTIONS INC. DATED NOVEMBER 23, 2022.
  - GEOTECHNICAL INFORMATION PROVIDED BY CMT ENGINEERING INC. DATED DECEMBER 19, 2020.
  - EXISTING HYDRO INFORMATION PROVIDED BY HYDRO ONE ON AUGUST 24, 2022.
  - GRCA REGULATION INFORMATION OBTAINED FROM THE GRAND RIVER CONSERVATION AUTHORITY.
  - EXISTING GAS INFORMATION PROVIDED BY ENBRIDGE ON AUGUST 27, 2022.
  - EXISTING BELL CABLE LINE INFORMATION PROVIDED BY BELL CANADA ON SEPTEMBER 08, 2022.
  - DRAFT PLAN PROVIDED BY VAN HARTEN SURVEYING INC. DATED SEPTEMBER 05, 2024.
  - PROPOSED DWELLING AND SEPTIC BED LAYOUTS OBTAINED FROM VAN HARTEN SURVEYING INC. REPORT 'SEWAGE SYSTEM & WATER SUPPLY CONSULTATION' DATED SEPTEMBER 29, 2023.
  - SEASONAL HIGH GROUNDWATER CONTOURS PROVIDED BY HYDROGEOLOGY CONSULTING SERVICES INC. RECEIVED SEPTEMBER 26, 2022.
  - EXISTING ROCK DRILL LOCATION OBTAINED FROM GAMSBY AND MANNER LIMITED DRAWING 'NAPIER STREET - ROAD RECONSTRUCTION' REV 2 (JAN 1994) AND JOHN VANDERWELLES MARK-UPS RECEIVED ON FEBRUARY 03, 2023. LOCATION IS APPROXIMATE AND CONTRACTOR IS TO CONFIRM LOCATION PRIOR TO CONSTRUCTION.

**BENCH MARKS :**

SITE BENCHMARK:  
ELEV = 445.40  
IB 375 ON NORTHWEST CORNER OF LOT 1, CONCESSION 1, WEST OF THE GRAND RIVER.

THE POSITION OF POLE LINES, CONDUITS, WATERMANS, SEWERS AND OTHER UNDERGROUND AND OVERGROUND UTILITIES AND STRUCTURES IS NOT NECESSARILY SHOWN ON THE CONTRACT DRAWINGS AND WHERE SHOWN THE ACCURACY OF THE POSITION OF SUCH UTILITIES AND STRUCTURES IS NOT GUARANTEED.

BEFORE STARTING WORK, THE CONTRACTOR SHALL INFORM HIMSELF OF THE EXACT LOCATION OF ALL SUCH UTILITIES AND STRUCTURES AND SHALL ASSUME ALL LIABILITY FOR ANY DAMAGE TO THEM.

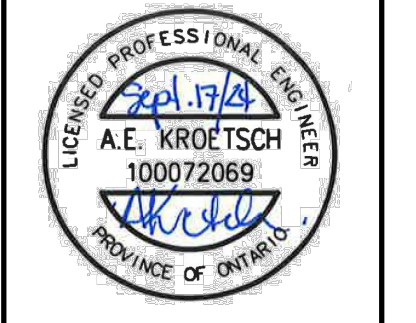

NO.	DATE	REVISION DESCRIPTION	CHKD
5.	2024/09/17	REVISED PER UPDATED DRAFT PLAN	A.E.K.
4.	2024/02/27	UPDATED SWM DESIGN AND ISSUED FOR APPROVAL	A.E.K.
3.	2023/10/12	REVISED PER UPDATED DRAFT PLAN AND ISSUED FOR APPROVAL	A.E.K.
2.	2023/10/02	ISSUED FOR APPROVAL	A.E.K.
1.	2023/06/02	ISSUED FOR REVIEW	A.E.K.

**ALMA SUBDIVISION**

**EXACT CONSTRUCTION LTD**

**TOWNSHIP OF MAPLETON**

**CONCEPTUAL EROSION AND SEDIMENT CONTROL PLAN**

DRAWN BY:	APPROVED BY:	PROJECT NO.:	DRAWING NO.:
E.A.	A.E.K.	120139	8
DESIGNED BY:	DATE:	SCALE:	
A.E.K.	AUGUST 2022	1:1000	

FILE: H:\Projects\2024\240000\240000-001\240000-001.dwg - EBC Plan.dwg LAYOUT: CONCEPTUAL EROSION AND SEDIMENT CONTROL PLAN  
 LAST SAVED BY: E.A. (2024/08/20 11:52:00 AM) PLOTTED BY: A. Kroetsch (2024/08/20 11:52:00 AM)

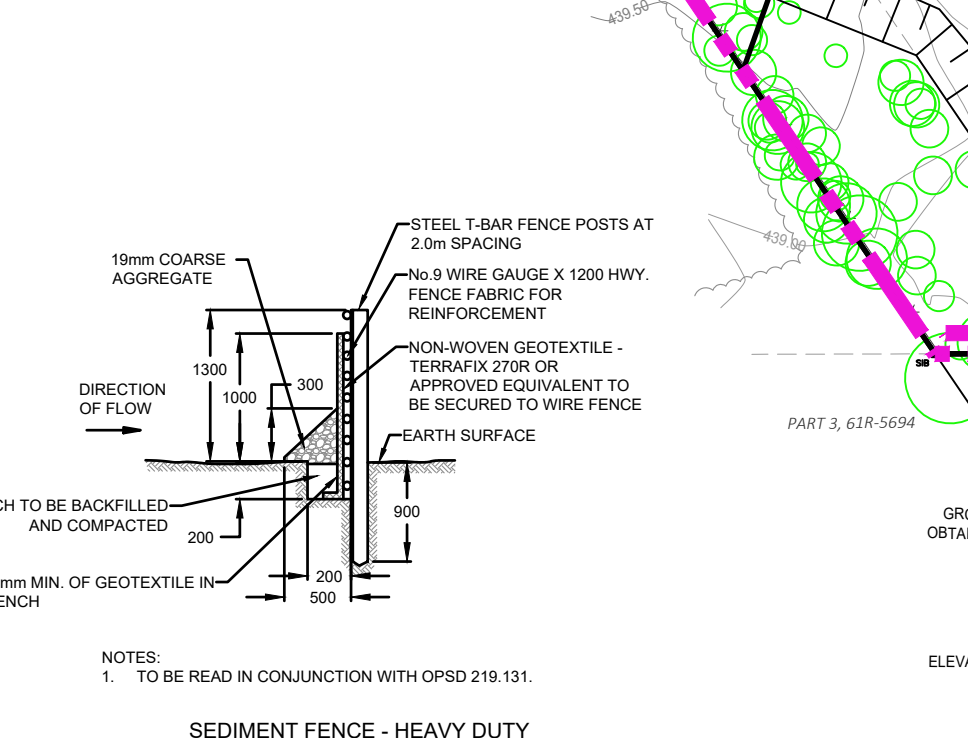
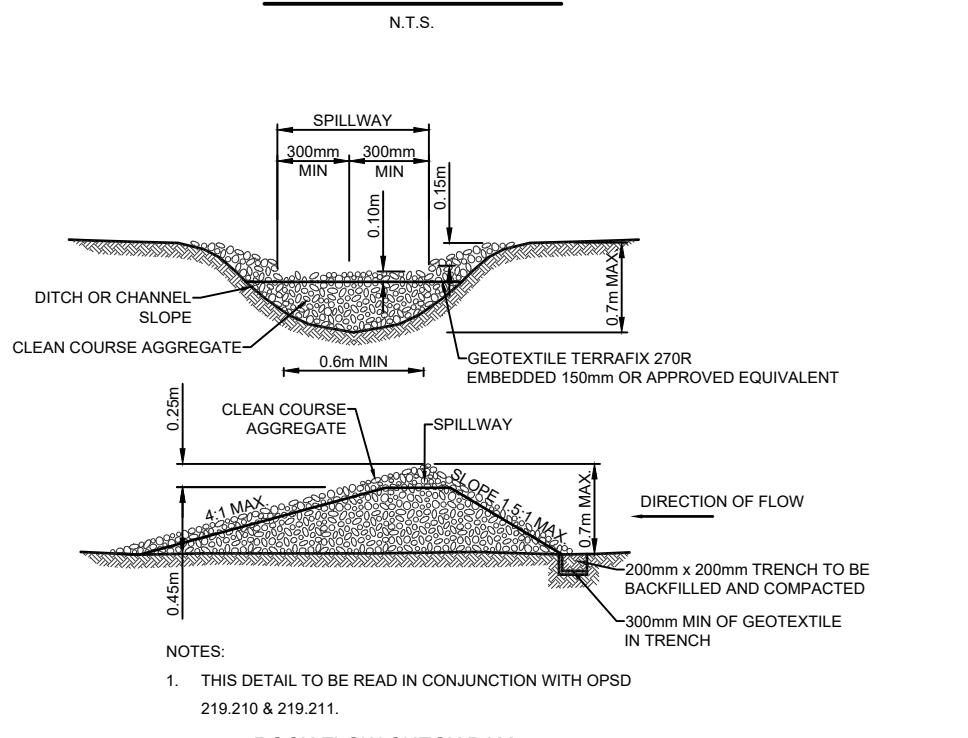
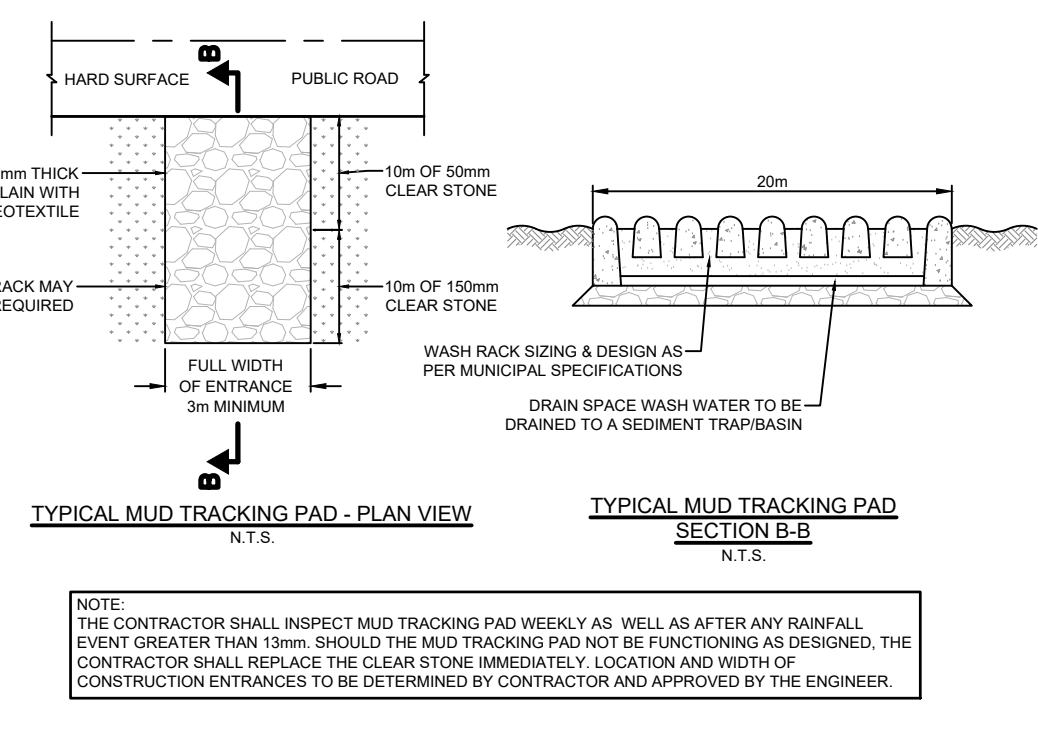

**TEMPORARY SEDIMENT POND SIZE REQUIREMENTS**

DRAINAGE AREA = 7.91 Ha
PERMANENT POOL VOLUME REQUIRED = 125m³/ha x 7.91 Ha = 988.75m³
PERMANENT POOL VOLUME PROVIDED = 1148m³
ACTIVE STORAGE REQUIRED = 125m³/ha x 7.91 Ha = 988.75m³
ACTIVE STORAGE PROVIDED = 5.64m³

